

Resource Number: 5BL 11306
Temporary Resource Number: 157508414002

OAHP1403
Rev. 9/98

COLORADO CULTURAL RESOURCE SURVEY

Architectural Inventory Form

Official eligibility determination
(OAHP use only)

Date _____ Initials _____
____ Determined Eligible- NR
____ Determined Not Eligible- NR
____ Determined Eligible- SR
____ Determined Not Eligible- SR
____ Need Data
____ Contributes to eligible NR District
____ Noncontributing to eligible NR District

I. IDENTIFICATION

1. Resource number: 5BL 11306
2. Temporary resource number: 157508414002
3. County: Boulder
4. City: Louisville
5. Historic building name: Norman House.
6. Current building name: Harnagel House
7. Building address: 836 Jefferson Avenue, Louisville, CO 80027. Alternate addresses for previous house on this property: 347 Jefferson, 840 Jefferson. Louisville addresses were changed in the 1930s.
8. Owner name and address: John Harnagel, 836 Jefferson Ave Louisville, CO 80027.



II. GEOGRAPHIC INFORMATION

9. P.M. 6 Township 1S Range 69W
SW ¼ of NE ¼ of NW ¼ of SE ¼ of section 8
10. UTM reference NAD 83
Zone 13 ; 488531 mE 4425383 mN
11. USGS quad name: Louisville, Colorado
Year: 1965 revised 1994 Map scale: 7.5' X 15' Attach photo copy of appropriate map section.
12. Lot(s): 12, 13 Block: 5
Addition: Jefferson Place Year of Addition: 1880
13. Boundary Description and Justification: The surveyed area is bounded by Jefferson Avenue on the west, Walnut Street on the north, an alley on the east, and a property line on the south.

III. Architectural Description

14. Building plan (footprint, shape): Rectangular plan
15. Dimensions in feet: Length 44 x Width 40
16. Number of stories: One
17. Primary external wall material(s): Brick
18. Roof configuration: Hipped roof

Resource Number: 5BL 11306
Temporary Resource Number: 157508414002

19. Primary external roof material: Asphalt
20. Special features: Porch
21. General architectural description: 836 Jefferson is a one-story house of brick construction, rectangular in plan, with its primary façade facing west to Jefferson Avenue. The foundation is concrete and the first floor is set high above the sloping grade to accommodate basement window wells on the north and south sides. The exterior is red brick. The roof is hipped, covered with dark brown asphalt shingles. All eaves are boxed and covered with white aluminum soffit material. The front entrance is centered on the west façade, with a tall concrete stoop, a concrete step, and a projecting hipped porch roof on two wrought iron posts. The front door is white paneled, probably metal, with a black metal security door. Windows are white aluminum sash, mostly sliders with some single-hung. The front façade has a large window flanked by sliders at the north end, and a bank of four long, narrow windows set high in the wall at the south end. The north and south elevations each have two basement window wells. The south face of the roof has a large roof-mounted evaporative cooler.
22. Architectural style/building type: Other
23. Landscaping or special setting features: Jefferson Place Subdivision is a historic residential neighborhood adjacent to downtown Louisville. The subdivision is laid out on a standard urban grid of narrow, deep lots with rear alleys. Houses are built to a fairly consistent setback line along the streets with small front lawns, deep rear yards and mature landscaping. Small, carefully maintained single-family residences predominate. Most of the houses are wood framed, one or one and one-half stories in height, featuring white or light-colored horizontal wood or steel siding, gabled or hipped asphalt shingled roofs and front porches. While many of the houses have been modified over the years, most of the historic character-defining features have been preserved. 836 Jefferson Avenue is of more recent construction and differs from historic Jefferson Place houses in its contemporary style, brick material and dark color, but it does retain the small, one-story scale of the historic houses. Newer, more contemporary houses are more common in the northwest corner of Jefferson Place (800 and 900 blocks Jefferson) than elsewhere in the subdivision. The 836 Jefferson property consists of a corner lot with Walnut Street to the north and Jefferson Avenue to the west. Front, side and rear yards are unfenced and feature simple grass lawns with gravel adjacent to the house. Two very large trees flank a concrete walk that leads from Jefferson Avenue to the tall front concrete stoop. The grade slopes down to the south to a wooden railroad tie retaining wall along the south property line. At the back of the house, the grade slopes down to the east. The back door on the east side of the house leads to a raised concrete stoop with 5 concrete steps leading north to a concrete walk to Walnut, and 5 concrete steps leading east to a small storage shed. The eastern portion of the lot contains a large detached garage with a wide concrete driveway that leads north to Walnut Street.
24. Associated buildings, features, or objects: At the east end of the property, there is a large garage with horizontal composition siding painted white, a gabled roof with dark brown asphalt shingles, a metal panel overhead garage door facing north, a white slider window facing west and a white door with black security door facing west to the back yard. A small storage shed between the house and the garage has white horizontal composition siding, a gabled roof with dark brown asphalt shingles and a metal panel door facing north.

IV. ARCHITECTURAL HISTORY

25. Date of Construction: Estimate: _____ Actual: 1983
Source of information: Louisville Building Permit
26. Architect: Unknown
Source of information: NA
27. Builder/Contractor: Fazio Construction
Source of information: Building permit
28. Original owner: John Norman (original owner of existing house)
Source of information: Building permit

Resource Number: 5BL 11306
Temporary Resource Number: 157508414002

29. Construction history (include description and dates of major additions, alterations, or demolitions): The house was built in 1983. There are no known modifications since then.
30. Original location X Moved Date of move(s):

V. HISTORICAL ASSOCIATIONS

31. Original use(s): Domestic, Single Dwelling
32. Intermediate use(s): N/A
33. Current use(s): Domestic, Single Dwelling
34. Site type(s): Urban residence
35. Historical background:

This building is located in Jefferson Place, the first residential subdivision in Louisville, but it is of more recent construction. According to Boulder County and City of Louisville building permit records, the existing house at 836 Jefferson was constructed in 1983, following the demolition of the original house that had been constructed in circa 1905. It was during the long eighty-plus years of ownership by the related Andrew/Norman/Harnagel family that the original house was torn down and the current house was constructed.

Isaac and Mary Ann Hearn Robbins and their three children owned and resided in the original house from the early 1900s until 1930. Isaac Robbins worked as a coal miner.

Edward and Ethel Andrew purchased the house in 1930. Edward was killed in a mine accident in 1940 and Ethel remained in the house with their daughter Lucille. Lucille married John Lewis Norman in the early 1950s and soon after, they owned and lived in the house along with Ethel. Ethel Andrew died in 1968. John Norman worked as a machinist at Rocky Flats. In 1983, John and Lucille had the old house demolished and the existing house built.

Lucille Norman died in 2000 and John Norman died in 2004, John Norman's heir, John Harnagel, became the owner of the house. He is the current owner and occupant.

Another address used for 836 Jefferson under Louisville's old address system was 347 Jefferson, and in the 1940 directory, when addresses were in a period of transition, its address was 840 Jefferson.

36. Sources of information:

Boulder County "Real Estate Appraisal Card – Urban Master," on file at the Carnegie Branch Library for Local History in Boulder, Colorado.

Boulder County Clerk & Recorder's Office and Assessor's Office public records, accessed through <http://recorder.bouldercounty.org>.

Directories of Louisville residents and businesses on file at the Louisville Historical Museum.

Census records and other records accessed through www.ancestry.com

Drumm's Wall Map of Louisville, Colorado, 1909.

Methodist Church Parish Map of Louisville, Colorado, circa 1923-25.

Archival materials on file at the Louisville Historical Museum.

Louisville building permit files

VI. SIGNIFICANCE

37. Local landmark designation: Yes No X Date of designation: NA

Designating authority: NA

37A. Applicable Local Landmark Criteria for Historic Landmarks:

A. Architectural.

- (1) Exemplifies specific elements of an architectural style or period.
- (2) Example of the work of an architect or builder who is recognized for expertise nationally, statewide, regionally, or locally.
- (3) Demonstrates superior craftsmanship or high artistic value.
- (4) Represents an innovation in construction, materials or design
- (5) Style particularly associated with the Louisville area.
- (6) Represents a built environment of a group of people in an era of history that is culturally significant to Louisville.
- (7) Pattern or grouping of elements representing at least one of the above criteria.
- (8) Significant historic remodel.

B. Social.

- (1) Site of historic event that had an effect upon society.
- (2) Exemplifies cultural, political, economic or social heritage of the community.
- (3) Association with a notable person or the work of a notable person.

C. Geographic/environmental

- (1) Enhances sense of identity of the community.
- (2) An established and familiar natural setting or visual feature that is culturally significant to the history of Louisville.

Does not meet any of the above local criteria.

Local Field Eligibility Assessment: Not eligible

37B. Applicable State Register of Historic Properties Criteria:

A. The property is associated with events that have made a significant contribution to history.

B. The property is connected with persons significant in history.

C. The property has distinctive characteristics of a type, period, method of construction or artisan.

D. The property has geographic importance.

E. The property contains the possibility of important discoveries related to prehistory or history.

Does not meet any of the above State Register criteria.

State Register Field Eligibility Assessment: Not eligible

38. Applicable National Register Criteria:

A. Associated with events that have made a significant contribution to the broad pattern of our history;

B. Associated with the lives of persons significant in our past;

Resource Number: 5BL 11306

Temporary Resource Number: 157508414002

- C. Embodies the distinctive characteristics of a type, period, or method of construction, or represents the work of a master, or that possess high artistic values, or represents a significant and distinguishable entity whose components may lack individual distinction; or
- D. Has yielded, or may be likely to yield, information important in history or prehistory.
- Qualifies under Criteria Considerations A through G (see Manual)
- X Does not meet any of the above National Register criteria

39. Area(s) of significance (National Register): NA

40. Period of significance: NA

41. Level of significance: NA National State Local

42. Statement of significance: This house is located in Louisville's first residential subdivision, Jefferson Place. As an example of more recent construction, not associated with Jefferson Place's early history, this property demonstrates the evolving nature of the subdivision, particularly in the northwest corner in the 800 and 900 blocks of Jefferson Avenue.

43. Assessment of historic physical integrity related to significance: The existing 1983 house has integrity of setting, location, design, materials, workmanship and feeling.

VII. NATIONAL REGISTER ELIGIBILITY ASSESSMENT

44. National Register eligibility field assessment:

Eligible Not Eligible X Need Data

45. Is there National Register district potential? Yes X No

Historic District Potential: Jefferson Place is eligible as a State Register and local historic district. There is potential for a National Register historic district. This property is non-contributing.

Discuss: This building is being recorded as part of a 2010-2011 intensive-level historical and architectural survey of Jefferson Place, Louisville's first residential subdivision, platted in 1880. The purpose of the survey is to determine if there is potential for National Register, State Register or local historic districts. Jefferson Place is eligible as a State Register historic district under Criterion A, Ethnic Heritage, European, for its association with European immigrants who first lived here and whose descendants continued to live here for over fifty years. The period of significance for the State Register historic district is 1881 – 1980. Jefferson Place is potentially eligible as a National Register historic district under Criterion A, Ethnic Heritage, European. However it needs data to determine dates of some modifications, and to more definitely establish the significant impacts of various European ethnic groups on the local culture of Louisville. The period of significance of a National Register district is 1881 – 1963. Jefferson Place is eligible as a local Louisville historic district under local Criterion B, Social, as it exemplifies the cultural and social heritage of the community.

European immigrant families flocked to Colorado coal mining communities, including Louisville, in the late nineteenth and early twentieth centuries in search of economic opportunities they could not find in their own countries. Louisville's Welch Coal Mine, along with other mines in the area, recruited skilled workers from western Europe. In the early years before 1900, most of the miners who lived in Jefferson Place came from English-speaking countries.

Immigrants from England brought a strong tradition and expertise in coal mining. The English are widely credited with developing the techniques of coal mining that were used locally, and they taught these techniques to other miners. The British mining culture was instilled in the early Colorado coal mines. English immigrants also brought expertise in other necessary skills such as blacksmithing and chain forging.

Later Jefferson Place residents arrived from Italy, France, Austria, Germany, Hungary, Slovakia, and Slovenia, among other places. The Italians eventually became the largest single ethnic group in Jefferson Place and in

Resource Number: 5BL 11306

Temporary Resource Number: 157508414002

Louisville as a whole. About one-third of the houses in Jefferson Place were owned and occupied by Italian immigrants. Italian immigrants left their mark on Louisville in the food and beverage industries. To the present day, downtown Louisville is known throughout the Front Range for its tradition of Italian restaurants. The impacts of the heritage and customs of the other European ethnic groups could be significant, but are not well documented and need further investigation.

If there is National Register district potential, is this building: Contributing ___ Noncontributing X

46. If the building is in existing National Register district, is it: Contributing ___ Noncontributing _____

The property is not within an existing National Register district.

VIII. RECORDING INFORMATION

47. Photograph numbers: 5BL11306_836Jefferson_01 through 5BL11306_836Jefferson_06.

Digital images filed at: City of Louisville, Planning Department

48. Report title: Historical and Architectural Survey of Jefferson Place Subdivision, Louisville, Colorado

49. Date(s): 2013

50. Recorder(s): Kathy and Leonard Lingo, Avenue L Architects, and Bridget Bacon, City of Louisville

51. Organization: Avenue L Architects

52. Address: 3457 Ringsby Court Suite 317, Denver, CO 80216

53. Phone number(s): (303) 290-9930

NOTE: Please include a sketch map, a photocopy of the USGS quad map indicating resource location, and photographs.

Colorado Historical Society - Office of Archaeology & Historic Preservation
1200 Broadway, Denver, CO 80203 (303) 866-3395

Resource Number: 5BL 11306
Temporary Resource Number: 157508414002

Resource Number: 5BL11306

Architectural Inventory Form
USGS Location Map

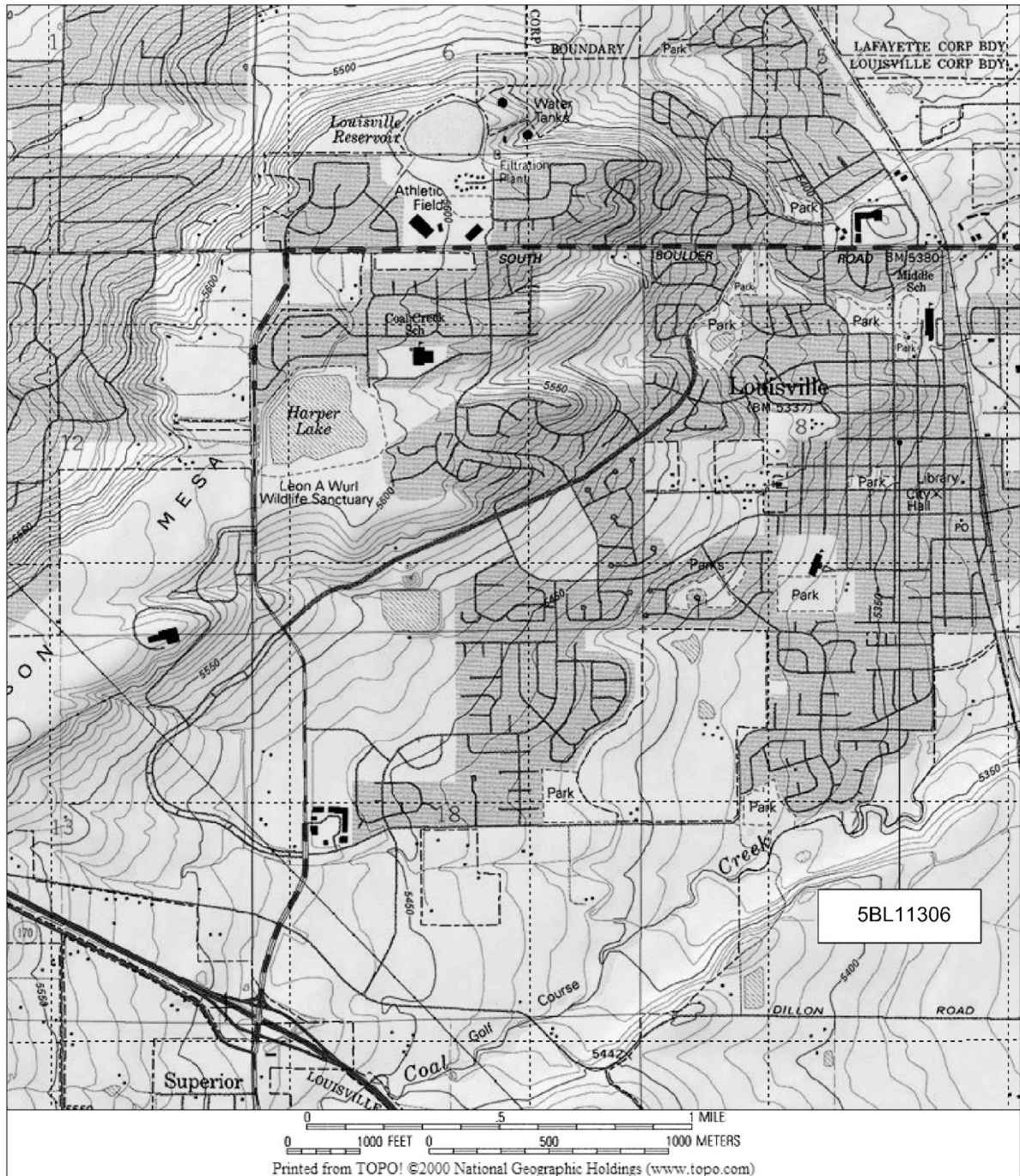

836 Jefferson Avenue, Louisville, Colorado

SOURCE: Extract of Louisville, Colorado
USGS map, 1994.



Resource Number: 5BL11306

Architectural Inventory Form
Site Location Map

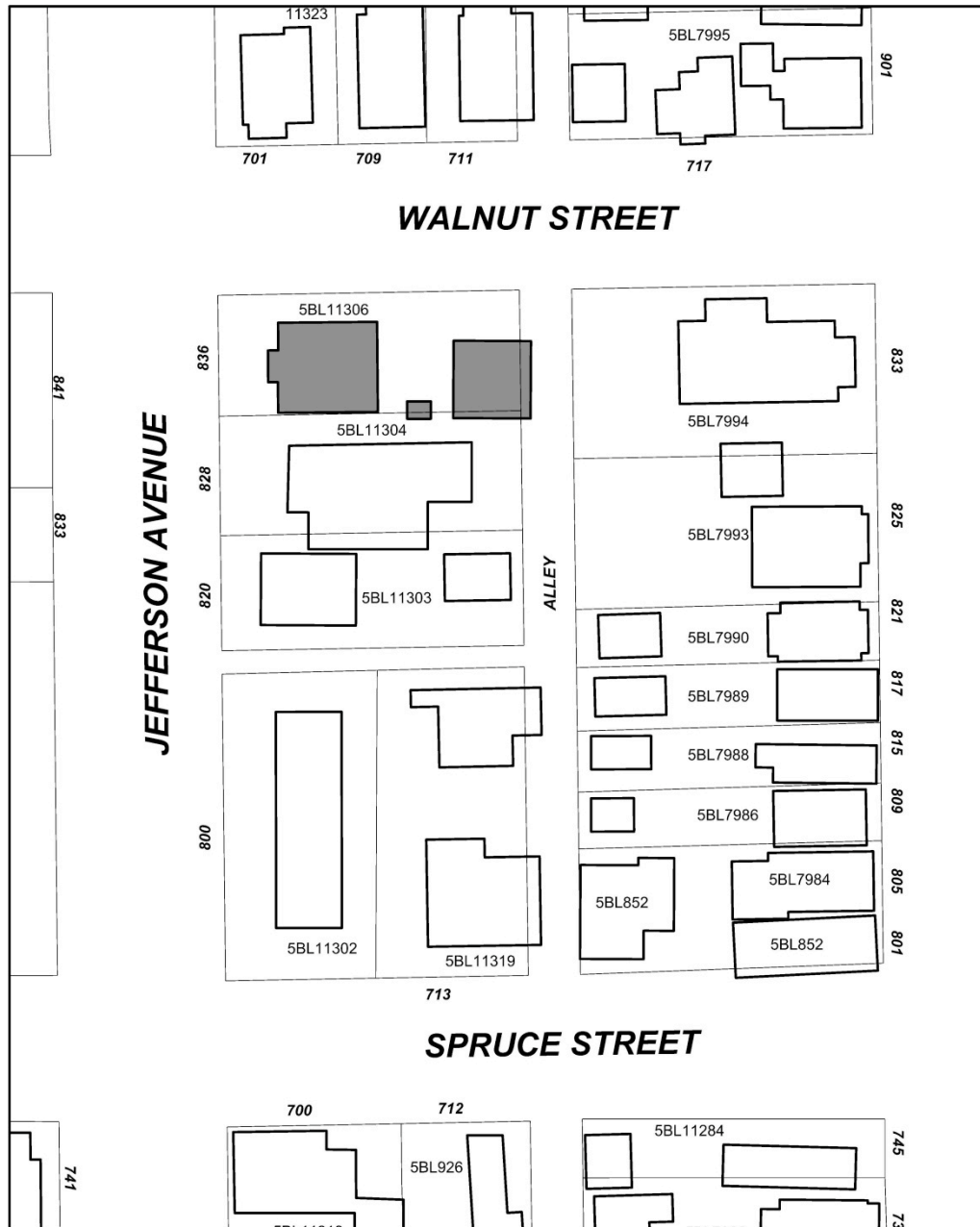

836 Jefferson Avenue, Louisville, Colorado

SOURCE: City of Louisville, Colorado
GIS Files.

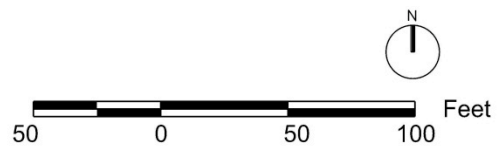

Resource Number: 5BL 11306
Temporary Resource Number: 157508414002



5BL11306_836Jefferson_01 west



5BL11306_836Jefferson_02 southwest

Resource Number: 5BL 11306
Temporary Resource Number: 157508414002



5BL11306_836Jefferson_03 north



5BL11306_836Jefferson_04 east

Resource Number: 5BL 11306
Temporary Resource Number: 157508414002



5BL11306_836Jefferson_05 garage northeast



5BL11306_836Jefferson_06 garage south