

COLORADO CULTURAL RESOURCE SURVEY

Architectural Inventory Form

(Page 1 of 5)

I. IDENTIFICATION

1. Resource number: **5BL8021**
2. Temporary number: **N/A**
3. County: **Boulder**
4. City: **Louisville**
5. Historic building name: **Delpizzo House**
6. Current building name: **Conner/ Henriksen House**
7. Building address: **1032 Main Street**
8. Owner name: **Neal Conner & Heidi Henriksen**
Owner address: **P.O. Box 311**
Mendham, NJ 07945

II. GEOGRAPHIC INFORMATION

9. P.M. **6th** Township **1S** Range **69W**
SW¼ of **SW**¼ of **SE**¼ of **NE**¼ of section **8**
10. UTM reference
Zone **13**
Easting: **488790**
Northing: **4425400**
11. USGS quad name: **Louisville, Colorado**
Year: **1965 (Revised 1994) 7.5'**
12. Lot(s): **8** Block: **17**
Addition: **Caledonia Place** Year of Addition **1890**
13. Boundary Description and Justification: **This legally defined parcel encompasses but does not exceed the land historically associated with this property.**

Official Eligibility Determination

(OAHP use only)

- Date _____ Initials _____
- Determined Eligible - National Register
 Determined Not Eligible - National Register
 Determined Eligible - State Register
 Determined Not Eligible - State Register
 Needs Data
 Contributes to eligible National Register District
 Noncontributing to eligible National Register District

III. ARCHITECTURAL DESCRIPTION

14. Building plan (footprint, shape):
Rectangular Plan
15. Dimensions in feet: **884 square feet**
16. Number of stories: **one**
17. Primary external wall material
Stucco
18. Roof configuration (enter one):
Gabled Roof / Front Gabled Roof
19. Primary external roof material (enter one):
Asphalt Roof
20. Special features (enter all that apply):
Porch
Chimney
Fence

22. Architectural style / building type:

Bungalow



21. General Architectural Description

This property is located on the east side of Main Street, to the north of downtown Louisville. It is comprised of a house, along with a garage, a chicken house and a storage shed. Featuring a rectangular plan, the house is a one-story, wood-frame, dwelling, built in the Bungalow style. It is supported by a low concrete foundation, the exterior walls are painted yellow stucco, and the roof is a moderately-pitched clipped front gable. The roof has brown asphalt shingles, and exposed rafter ends. A red brick chimney is located on the ridge. Windows are entirely single and paired 3/1 double-hung sash (ribbon style), with painted white wood frames and surrounds. A stained natural brown solid wood door, with three upper sash lights, and with an aluminum storm door, opens onto a concrete porch located on the west elevation (facade). The porch is covered by a clipped gable hood, supported by painted white tapered squared posts. A painted white wood-paneled door, with an aluminum screen door, leads into an enclosed rear porch, on the building's east (rear) elevation.

The **Garage** is located near the alley, at the southeast corner of the lot. This is a one-story, wood-frame structure, supported by a low concrete perimeter walls foundation. The garage's walls and gabled roof are clad with corrugated metal. There are no windows. A set of paired, wood and corrugated metal garage doors open toward the alley on the building's east elevation.

The **Chicken House** is located near the alley, at the northeast corner of the lot. This is a wood-frame structure, with wood timbers on grade as its foundation, and with unpainted horizontal wood plank walls. Some of the exterior walls have been covered with tin, and the shed roof is covered with rolled asphalt over 1x wood decking and 2x wood rafters. A band of three screened window openings is located along the east end of the south elevation. Two vertical wood plank doors, are located to the west end of the south elevation. Built onto the west end of this building is a small wood frame and corrugated metal shed, which appears traditionally to have been used as a tool shed.

The **Storage Shed** is located just three feet west of the garage. This is a small wood frame structure with a wood timbers on grade foundation, and with corrugated metal exterior walls. It has a shed roof, with corrugated metal over 1x wood decking and 2x wood rafters. There are no windows. An unpainted vertical wood plank door, side hinged with metal strap hinges, is located on the west elevation.

29. Construction History (include description and dates of major additions, alterations, or demolitions:

Boulder County Assessor records indicate that this house was constructed in 1910. There have been no additions, and no noticeable exterior alterations, subsequent to the original construction.

23. **Landscape or setting special features:**
This property is located on the east side of Main Street, north of downtown Louisville.

24. Associated buildings, features, or objects
Garage, Chicken House, Storage Shed

IV. ARCHITECTURAL HISTORY

25. Date of Construction:
Estimate **1910**
Actual

Source of information:
Boulder County Assessor records

26. Architect:
n/a

Source of information:
n/a

27. Builder/ Contractor:
unknown

Source of information:
n/a

28. Original owner:
unknown

Source of information:
n/a

30. Original location: **yes**
Moved **no**
Date of move(s) **n/a**

V. HISTORICAL ASSOCIATIONS

31. Original use(s): **Single Dwelling**
32. Intermediate use(s): **Single Dwelling**
33. Current use(s): **Single Dwelling**
34. Site type(s): **Residence**

35. Historical Background

This house was constructed circa 1910, and has served as a single family dwelling since that time. In the late 1920s, this was the residence of Andrew L. and Martha Wing. Andrew was a coal miner. By the mid-1930s, this house had become the residence of another Louisville coal miner, Nicola (Nick) Delpizzo, and his wife Anna (Annie). Born in Italy, Mr. Delpizzo immigrated to America, and came to Louisville to work in the coal mines, at age nineteen. The Delpizzos owned and lived here into the early 1990s. After he retired from mining, Nick was an avid gardner. A 1991 *Boulder Daily Camera* newspaper article noted that at that time Mr. Delpizzo was the last known survivor of the 1939 Monarch Mine disaster which killed eight men.

36. Sources of Information

Conarroe, Carolyn. *The Louisville Story*, Louisville: Louisville Times Inc., 1978.

Polk's Boulder County Directory [generally published annually], Denver, Kansas City, and Salt Lake City: R.L. Polk and Company Publishers.

Polk's Longmont City Directory, [generally published annually], Denver, Kansas City, and Salt Lake City: R.L. Polk and Company, Publishers, 1966 - 1997.

"Remembering the Mines." *Boulder Daily Camera*, July 24, 1991, p. 7.

VI. SIGNIFICANCE

37. Local landmark designation:

Yes

No

Date of Designation: n/a

38. Applicable National Register Criteria

A. Associated with events that have made a significant contribution to the broad patterns of our history;

B. Associated with the lives of persons significant in our past;

C. Embodies the distinctive characteristics of a type, period, or method of construction, or represents the work of a master, or that possess high artistic values, or represents a significant and distinguishable entity whose components may lack individual distinction;

D. Has yielded, or may be likely to yield information important in history or prehistory;

Qualifies under Criteria Considerations A through G (see Manual).

Does not meet any of the above National Register criteria.

39. Area(s) of Significance:

Architecture; Community Planning and Development; Ethnic Heritage / European

40. Period of Significance: 1910 - 1950

41. Level of Significance:

National:

State:

Local:

42. Statement of Significance

This house is historically significant, relative to National Register Criterion A, for its associations with the Delpizzo family, and with Louisville's residential development during the first half of the twentieth century. The property is also historically significant for its representation of this Louisville neighborhood's ethnic Italian heritage. The building is architecturally significant for its Bungalow style of architecture. For these reasons, this property is eligible for individual listing in the National Register of Historic Places. The garage, chicken house, and shed all date from the period of significance, and they do contribute to the property's historic setting, and sense of time and place.

43. Assessment of historic physical integrity related to significance:

This property exhibits an extremely high level of historic integrity. There have been no additions and no alterations to the exterior of the house. The three secondary structures all date from the period of significance, and no modern structures have been built on the lot.

VII. NATIONAL REGISTER ELIGIBILITY ASSESSMENT

44. National Register eligibility field assessment:

Eligible: **xx**

Not Eligible:

Need Data:

45. Is there National Register district potential?

Yes:

No: **xx**

Discuss: **Houses and other buildings in this area north of downtown Louisville, do not collectively display sufficient historical integrity to qualify as a National Register Historic District.**

If there is National Register district potential, is this building:

Contributing: **n/a**

Noncontributing: **n/a**

46. If the building is in an existing National Register district, is it:

Contributing: **n/a**

Noncontributing: **n/a**

VIII. RECORDING INFORMATION

47. Photograph numbers:

Roll: **CM-9, CM-10**

Frame(s): **32-36, 1**

Negatives filed at: **City of Louisville, Administration
749 Main Street
Louisville, Colorado 80027**

48. Report title: **"Old Town" Louisville Historical Building Survey**

49. Date: **April 14, 2000**

50. Recorder(s): **Carl McWilliams**

51. Organization: **Cultural Resource Historians**

52. Address: **1607 Dogwood Court
Fort Collins, Colorado 80525**

53. Phone number: **970/493-5270**

Short Street

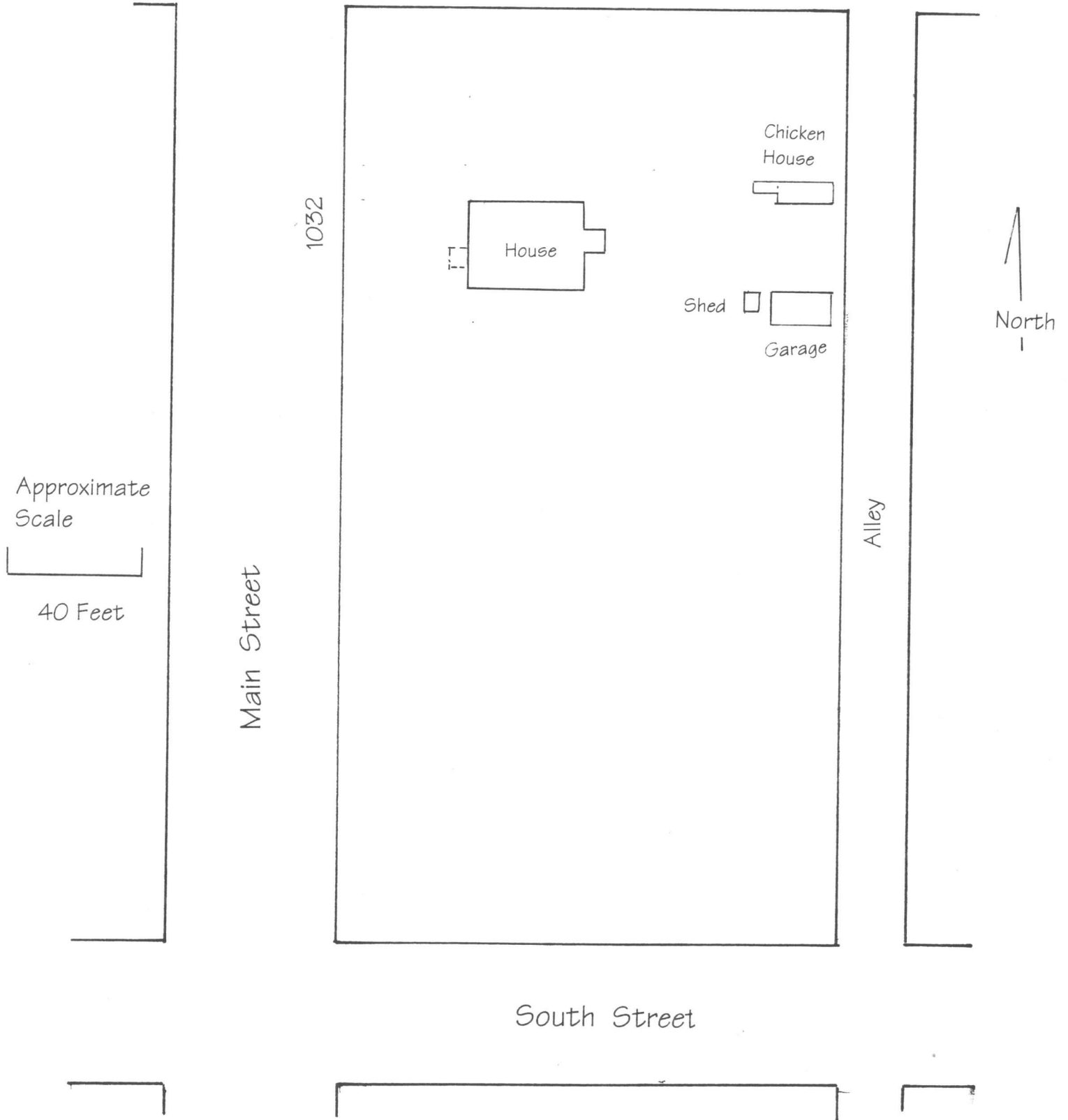

Main Street

1032

House

Chicken House

Shed

Garage

Alley

North

South Street

SKETCH MAP

1032 Main Street, Louisville, Colorado

LOUISVILLE QUADRANGLE
COLORADO
7.5 MINUTE SERIES (TOPOGRAPHIC)

4964 11 SE
(ERIE)

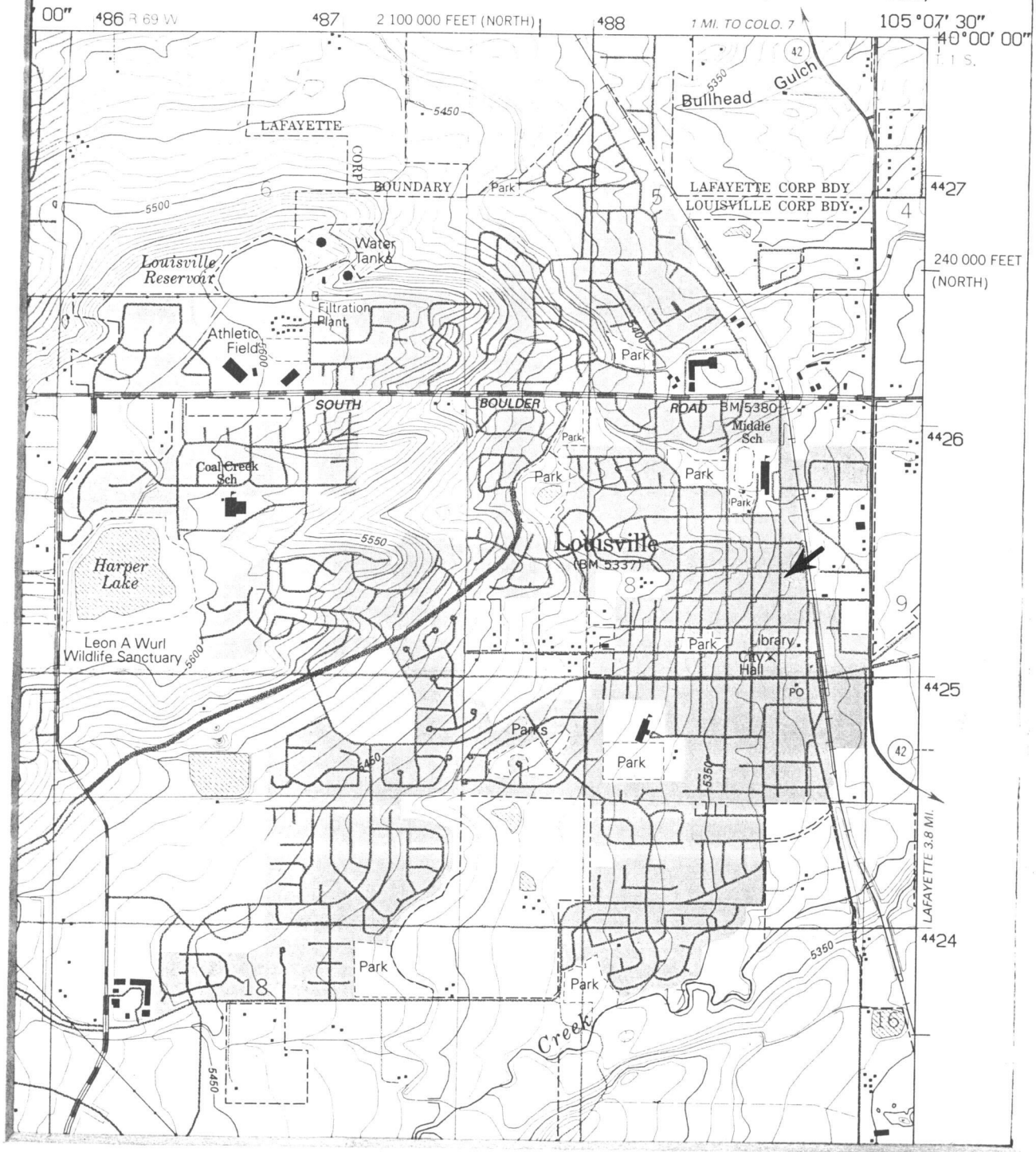

• • • LOCATION MAP • • •

1032 Main Street, Louisville, Colorado



