

COLORADO CULTURAL RESOURCE SURVEY

Architectural Inventory Form

(Page 1 of 5)

I. IDENTIFICATION

- 1. Resource number: **5BL949**
- 2. Temporary number: **N/A**
- 3. County: **Boulder**
- 4. City: **Louisville**
- 5. Historic building name: **DeSalvo House**
- 6. Current building name: **Pavelich House**
- 7. Building address: **1021 Main Street**
- 8. Owner name: **Nancy E. & John D. Pavelich**
Owner address: **643 Manor Wood Lane
Louisville, CO 80027**

II. GEOGRAPHIC INFORMATION

- 9. P.M. **6th** Township **1S** Range **69W**
SW¼ of **SW**¼ of **SE**¼ of **NE**¼ of section **8**
- 10. UTM reference
Zone **13**
Easting: **488750**
Northing: **4425370**
- 11. USGS quad name: **Louisville, Colorado**
Year: **1965 (Revised 1994) 7.5'**
- 12. Lot(s): **5, 6** Block: **1**
Addition: **Barclay Place** Year of Addition **1897**
- 13. Boundary Description and Justification: **This legally defined parcel encompasses but does not exceed the land historically associated with this property.**

Official Eligibility Determination

(OAHP use only)

- Date _____ Initials _____
- Determined Eligible - National Register
 - Determined Not Eligible - National Register
 - Determined Eligible - State Register
 - Determined Not Eligible - State Register
 - Needs Data
 - Contributes to eligible National Register District
 - Noncontributing to eligible National Register District

III. ARCHITECTURAL DESCRIPTION

- 14. Building plan (footprint, shape):
Rectangular Plan
- 15. Dimensions in feet: **1245 square feet**
- 16. Number of stories: **1½**
- 17. Primary external wall material
Wood / Horizontal Siding
- 18. Roof configuration (enter one):
Gabled Roof / Side Gabled Roof
- 19. Primary external roof material (enter one):
Asphalt Roof
- 20. Special features (enter all that apply):
Porch
Balcony
Chimney
Fence

22. Architectural style / building type:

**Other Style
Wood-Frame Side
Gabled Dwelling)**



21. General Architectural Description

This 1½-story wood-frame house is situated on a large lot, on the west side of Main Street, north of downtown Louisville. The building is supported by a painted blue low concrete foundation, and its exterior walls are narrow, painted blue, horizontal wood siding, with painted white 1" by 4" corner boards. The roof is a moderately-pitched side gable, with grey asphalt shingles and boxed eaves. There are three red brick chimneys - one located on the ridge, and the other two located on the roofs of additions to the west (rear) elevation. One of these chimneys has a distinctive corbelled cap. A gabled wall dormer is located on the facade. A canted hipped-roof bay window, with three 1/1 double-hung sash windows, is located on the south elevation. The building's other windows are predominantly 1/1 double-hung sash, with painted red wood frames, and painted white wood surrounds, and with wood cornices. Windows on the additions to the west are single-light fixed-panes, or casement type windows. The house's facade fronts toward Main Street on the east elevation. A distinctive painted white wood-paneled entry door, here, has one upper sash light, a projecting sawtooth top rail, a projecting locking rail, and carved panels. This door opens onto a 4-step tongue-and-groove wood porch, which extends nearly the full length of the facade. Painted blue wood-frame half-walls, and painted red and white turned columns and engaged columns, support a flat porch roof. The porch roof and columns are decorated with a frieze, and with scrolled brackets. The porch roof also serves as a second story balcony. The balcony features an open painted white wood balustrade, with turned balusters. A stained natural brown glass-in-wood-frame door opens onto the balcony from the upper half story, where the dormer is located. A secondary entrance is located at the west end of the south elevation, where a painted blue and white wood-paneled door opens onto a concrete stoop.

A **Storage Shed** is located in the backyard, west of the house along the south property line. This is a one-story wood-frame building, supported by a wood timbers on grade foundation. It has vertical wood plank walls, and a shed roof, with rolled asphalt roofing, over 1x wood decking and 2x wood rafters. Paired wood-paneled doors are located on the north elevation.

29. Construction History (include description and dates of major additions, alterations, or demolitions:

Boulder County Assessor records list 1908 as this building's date of construction. The original 1½-story side-gabled house measured 24' N-S by 16' E-W. Two single-story additions to the west (rear) elevation, predate 1948. One of these additions, with a gable and shed roof, measures 24' N-S by 14' E-W; the other addition, with a shed roof, measures 12' N-S by 10' E-W.

23. Landscape or setting special features:

This property is located on the west side of Main Street, north of downtown Louisville. The Louisville Historical Museum and Miner's Cabin are to the south.

24. Associated buildings, features, or objects **Storage Shed**

IV. ARCHITECTURAL HISTORY

25. Date of Construction:

Estimate

Actual **1908**

Source of information:

Boulder County Assessor records

26. Architect:

n/a

Source of information:

n/a

27. Builder/ Contractor:

unknown

Source of information:

n/a

28. Original owner:

unknown

Source of information:

n/a

30. Original location: **yes**

Moved **no**

Date of move(s) **n/a**

V. HISTORICAL ASSOCIATIONS

31. Original use(s): **Single Dwelling**
32. Intermediate use(s): **Single Dwelling**
33. Current use(s): **Single Dwelling**
34. Site type(s):

35. Historical Background

This house was built in 1908, and has served as a single family residence since that time. Boulder County directories indicate that by 1920, this was the home of Joseph and Carmela DeSalvo. Like many men of his generation in Louisville, Mr. DeSalvo worked as a coal miner. The DeSalvos, who had come to Louisville sometime between 1904 and 1916, lived in this house into the late 1950s. Other members of the DeSalvo family who lived here over the years included William (also a miner), Jennie, Mary, and Joseph Jr.

In the early 1960s, the property was sold by the DeSalvos to Victor and Josephine Petrelli. The Petrellis also owned property across the street at 1016 Main Street. From the 1970s to the present (2000) this property has apparently been used as a rental, and has had several tenants. Nancy E. & John D. Pavelich, the current owners, have held the property since June of 1996.

36. Sources of Information

(Boulder County) "Real Estate Appraisal Card - Urban Master", on file at the Boulder Carnegie Library.

Conarroe, Carolyn. *The Louisville Story*, Louisville: Louisville Times Inc., 1978.

Mehls, Steven F., and Mehls, Carol Drake. "Colorado Historical Society, Historic Building Inventory Record", (1021 Main Street), July 28, 1985. On file at the Colorado Historical Society, Office of Archaeology and Historic Preservation, Denver, CO.

Polk's Boulder County Directory [generally published annually], Denver, Kansas City, and Salt Lake City: R.L. Polk and Company Publishers.

Polk's Longmont City Directory, [generally published annually], Denver, Kansas City, and Salt Lake City: R.L. Polk and Company, Publishers, 1966 - 1997.

VI. SIGNIFICANCE

37. Local landmark designation:

Yes

No

Date of Designation: n/a

38. Applicable National Register Criteria

A. Associated with events that have made a significant contribution to the broad patterns of our history;

B. Associated with the lives of persons significant in our past;

C. Embodies the distinctive characteristics of a type, period, or method of construction, or represents the work of a master, or that possess high artistic values, or represents a significant and distinguishable entity whose components may lack individual distinction;

D. Has yielded, or may be likely to yield information important in history or prehistory;

Qualifies under Criteria Considerations A through G (see Manual).

Does not meet any of the above National Register criteria.

39. Area(s) of Significance:

Community Planning and Development; Ethnic Heritage / European

40. Period of Significance: 1908 - 1950

41. Level of Significance:

National:

State:

Local:

42. Statement of Significance

This house is historically significant, relative to National Register Criterion A, for its associations with the DeSalvo family, and with residential development in Louisville during the first half of the twentieth century. The property is also historically significant for its representation of this Louisville neighborhood's ethnic Italian heritage. The building is architecturally significant because it is one of the community's best examples of a wood frame side gabled dwelling, dating from the early 1900s. For these reasons, this property is eligible for individual listing in the National Register of Historic Places under Criteria A and C.

43. Assessment of historic physical integrity related to significance:

This property exhibits a high level of historic integrity. Two additions to the rear elevation are more than fifty years old, and are architecturally compatible with the building's original construction.

VII. NATIONAL REGISTER ELIGIBILITY ASSESSMENT

44. National Register eligibility field assessment:

Eligible: **xx**

Not Eligible:

Need Data:

45. Is there National Register district potential?

Yes: **xx**

No:

Discuss: **Historic buildings along Main Street in downtown Louisville, which have retained a sufficient degree of historical integrity, could comprise a National Register historic district. A downtown Louisville historic district could extend far enough north to incorporate this property.**

If there is National Register district potential, is this building:

Contributing: **xx**

Noncontributing:

46. If the building is in an existing National Register district, is it:

Contributing: **n/a**

Noncontributing: **n/a**

VIII. RECORDING INFORMATION

47. Photograph numbers:

Roll: **CM-10**

Frame(s): **6-9**

Negatives filed at: **City of Louisville, Administration
749 Main Street
Louisville, Colorado 80027**

48. Report title: **"Old Town" Louisville Historical Building Survey**

49. Date: **April 14, 2000**

50. Recorder(s): **Carl McWilliams**

51. Organization: **Cultural Resource Historians**

52. Address: **1607 Dogwood Court
Fort Collins, Colorado 80525**

53. Phone number: **970/493-5270**

Short Street

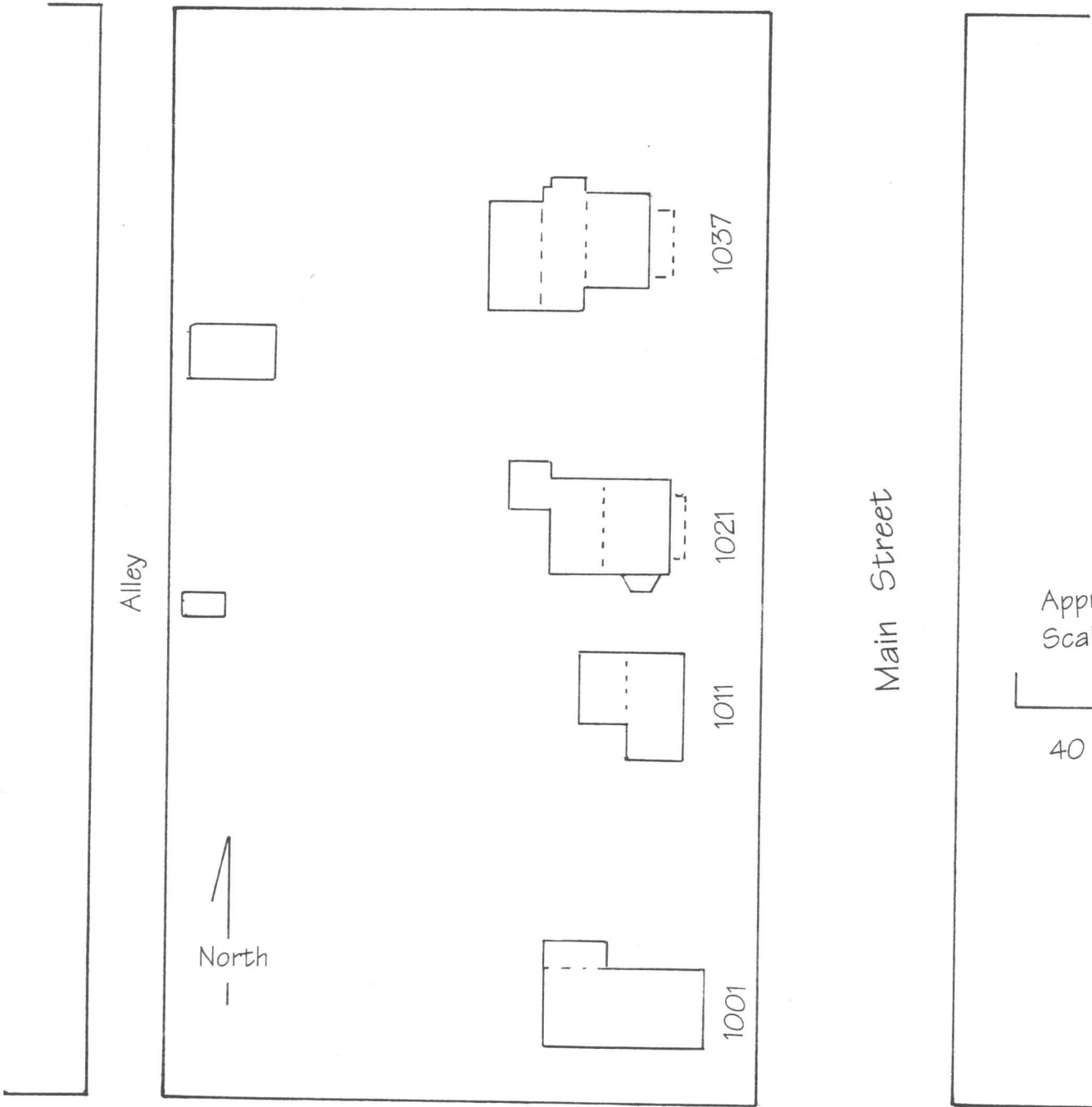

South Street

• • • SKETCH

MAP • • •

1021 Main Street, Louisville, Colorado

LOUISVILLE QUADRANGLE
 COLORADO
 7.5 MINUTE SERIES (TOPOGRAPHIC)

4964 11 SE
 (E7/E)

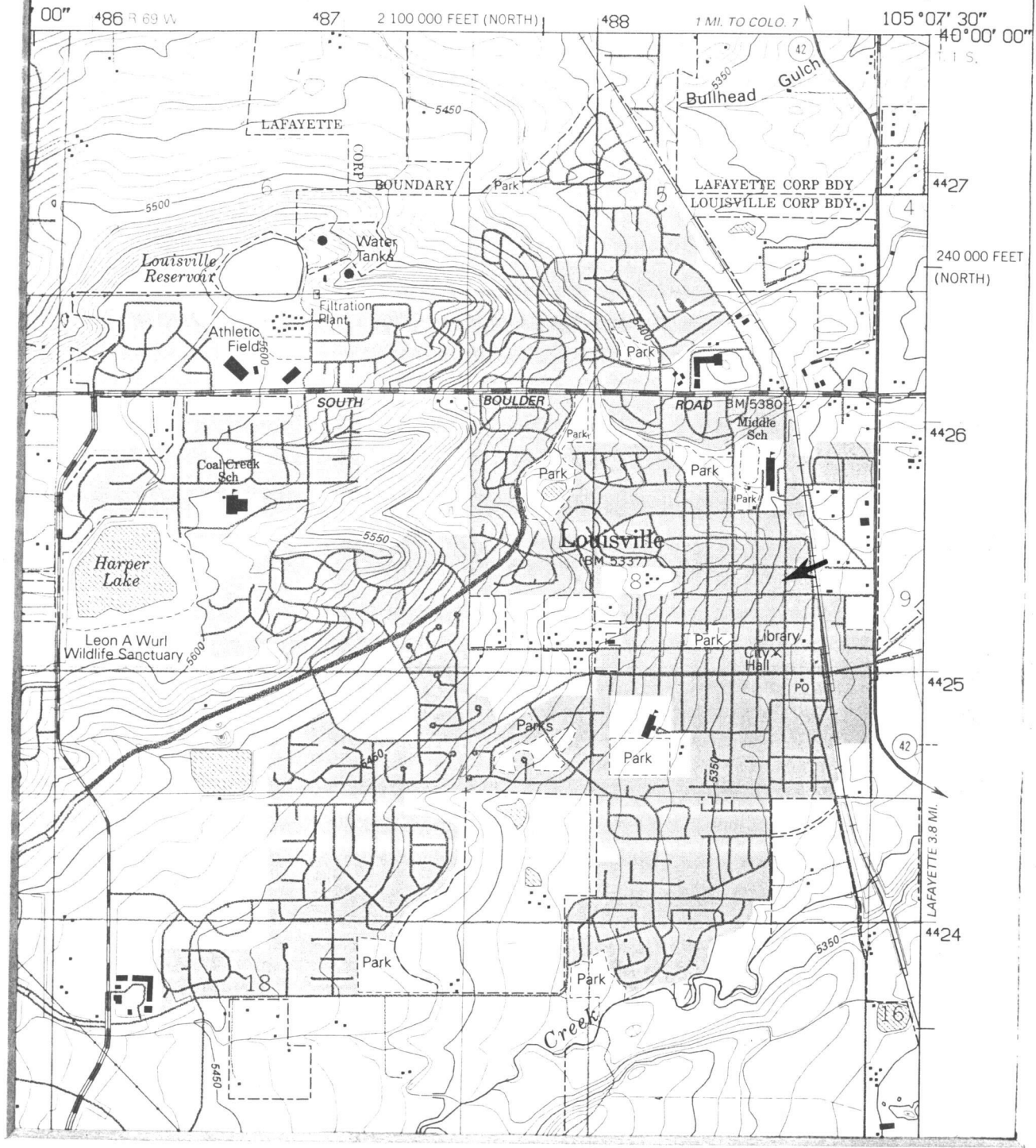

. . . LOCATION MAP . . .

1021 Main Street, Louisville, Colorado

1021 MAIN STREET



1051 MAIN STREET

