

COLORADO CULTURAL RESOURCE SURVEY

Architectural Inventory Form

(Page 1 of 5)

I. IDENTIFICATION

- 1. Resource number: **5BL8012**
- 2. Temporary number: **N/A**
- 3. County: **Boulder**
- 4. City: **Louisville**
- 5. Historic building name: **Colacci's Restaurant**
- 6. Current building name: **Pasquini's Pizzeria**
- 7. Building address: **816 Main Street**
- 8. Owner name: **Antonio Pasquini**
Owner address: **815 S. Emerson Street**
Denver, CO 80209

II. GEOGRAPHIC INFORMATION

- 9. P.M. **6th** Township **1S** Range **69W**
SW% of **NW**% of **NE**% of **SE**% of section **8**
- 10. UTM reference
Zone **13**
Easting: **488790**
Northing: **4425160**
- 11. USGS quad name: **Louisville, Colorado**
Year: **1965 (Revised 1994) 7.5'**
- 12. Lot(s): **9** Block: **2**
Addition: **Original Town of Louisville** Year of Addition **1878**
- 13. Boundary Description and Justification: **This legally defined parcel encompasses but does not exceed the land historically associated with this property.**

Official Eligibility Determination

(OAHP use only)

Date _____ Initials _____

- Determined Eligible - National Register
- Determined Not Eligible - National Register
- Determined Eligible - State Register
- Determined Not Eligible - State Register
- Needs Data
- Contributes to eligible National Register District
- Noncontributing to eligible National Register District

III. ARCHITECTURAL DESCRIPTION

- 14. Building plan (footprint, shape):
Rectangular
- 15. Dimensions in feet: **4231 square feet**
- 16. Number of stories: **one**
- 17. Primary external wall material
Wood / Weatherboard
Concrete / Concrete Block
- 18. Roof configuration (enter one):
Flat
- 19. Primary external roof material (enter one):
Asphalt Roof / Composition Roof
- 20. Special features (enter all that apply):
False Front

- 22. Architectural style / building type:

Late 19th and Early 20th Century American Movements / Commercial Style



21. General Architectural Description

The Colacci Restaurant building is located on the east side of Main Street, in downtown Louisville. The original building, to the west, measures approximately 35' by 70', and is of wood frame construction. The rear of the building, to the east, measures approximately 32' by 55', and is of concrete block construction dating from the 1950s. The building rests on a concrete or stone foundation, and the roof is flat. A parapet wall extends approximately three feet above the roof line, on the facade (east elevation), while somewhat lower parapet walls are located along the north and south elevations. The building's facade features a glass-in-steel-frame door, set within a recessed entryway. The door is flanked, within the entryway, by two glass-in-steel-frame windows. Another glass-in-steel-frame door, is located to the south of the main entry, and there are two glass-in-steel frame storefront display windows, on the facade. The lower facade wall is faced with pressed concrete, in a faux buff red sandstone pattern. The upper facade wall is clad with an applied metal facade, light beige in color, with a wide bright blue band. A large distinctive neon sign projects out from, and above the upper facade wall, advertising "**Colacci's Restaurant**." The east end of the building's south elevation is exposed, an four 1x1 horizontal sliding windows, in metal frames, are located here. Two similar windows are located on the building's east (rear) elevation, and there are two service entry doors, located on the east elevation, as well.

29. Construction History (include description and dates of major additions, alterations, or demolitions:

Sanborn Assessor maps, dated 1900 and 1908 provide evidence that this building was constructed sometime during those years. A 32' by 55' concrete block addition was put on the rear of the building in 1955. The building's facade was renovated, as the building was converted from a pool hall into Colacci's Restaurant, at the same time. Boulder County Assessor records suggest that the facade may have been renovated again in 1988.

23. Landscape or setting special features:

Colacci's Restaurant is located on the east side of Main Street, in the heart of downtown Louisville. Tulien's Restaurant is to the south, and the Main Street Market Place building is to the north.

24. Associated buildings, features, or objects
n/a**IV. ARCHITECTURAL HISTORY****25. Date of Construction:**
Estimate **ca. 1904**
Actual

Source of information:
Sanborn maps, 1900 and 1908.

26. Architect:
n/a

Source of information:
n/a

27. Builder/ Contractor:
unknown

Source of information:
n/a

28. Original owner:
unknown

Source of information:
n/a

30. Original location: **yes**
Moved **no**
Date of move(s) **n/a**

V. HISTORICAL ASSOCIATIONS

31. Original use(s): **Funerary / Mortuary**
32. Intermediate use(s): **Commerce and Trade / Specialty Store**
33. Current use(s): **Commerce and Trade / Restaurant**
34. Site type(s): **Commercial Building**

35. Historical Background

Sanborn insurance maps reveal that this building was constructed shortly after the turn of the twentieth century, and that early on an undertaker's business was located here. By 1936, Steven John was operating a beer parlor here. Within a few years, this establishment had become a billiards hall called "Johnnie's Place." Louis Schmelzer is listed as the business' manager in the 1940 Boulder County Directory. By 1950, Toney W. and Catherine LaSalle were operating the LaSalle Furniture Store at 816 Main Street. LaSalle's Furniture and Household Goods had previously been located at 813 Main Street, according to Boulder County Directories.

In 1955, this building was acquired by Anthony and Rita Colacci who opened Colacci's Restaurant here. Anthony is the son of Michael and Mary (Maria) Colacci, who had come to Louisville in the 1910s. The Colacci family, over the course of several decades, made an indelible mark on downtown Louisville, as they operated up to four Italian restaurants in a two block area along Main Street. The Colacci family's first restaurant, the Blue Parrot, has operated continuously at the southeast corner of Main and Pine Streets since the early 1920s. Other Colacci restaurants include: Colacci's Restaurant, which opened here at 816 Main Street in 1955; Luigi's, located at 808 Main Street from the mid-1960s to the mid-1980s; and Pasquale's, which was in business at 809 Main Street from the mid-1960s until 1997. Due primarily to the Colacci family, Louisville gained a reputation throughout the Denver metropolitan area as the place to go for Italian food. The Colacci's were involved in other retail businesses as well. In the 1940s and 1950s, Joseph Colacci (Michael and Mary's son) ran Tony and Jim's Service Station (later known as the Louisville Oil Company), at the northwest corner of Main and Pine, located diagonally across the street from the Blue Parrot. Joe Colacci later took over operation of the Blue Parrot, while his brother, Anthony, ran Colacci's Restaurant here at 816 Main Street. Earlier this year (2000) Colacci's Restaurant was acquired by Tony Pasquini, and the name was changed to Pasquini's Pizzeria. It remains a very popular Louisville eatery.

36. Sources of Information

(Boulder County) "Real Estate Appraisal Card - Urban Master", on file at the Boulder Carnegie Library.

"Colacci's Restaurant Gets New Owner, But Style and Food Will Stay the Same." *Boulder Daily Camera*, February 3, 1993, p. 1C.

Polk's Boulder County Directory [generally published annually], Denver, Kansas City, and Salt Lake City: R.L. Polk and Company Publishers.

Polk's Longmont City Directory, [generally published annually], Denver, Kansas City, and Salt Lake City: R.L. Polk and Company, Publishers, 1966 - 1997.

Sanborn Fire Insurance Maps, dated August 1893, November 1900, and August 1908.

VI. SIGNIFICANCE

37. Local landmark designation:

Yes

No **xx**

Date of Designation: **n/a**

38. Applicable National Register Criteria

A. Associated with events that have made a significant contribution to the broad patterns of our history;

B. Associated with the lives of persons significant in our past;

C. Embodies the distinctive characteristics of a type, period, or method of construction, or represents the work of a master, or that possess high artistic values, or represents a significant and distinguishable entity whose components may lack individual distinction;

D. Has yielded, or may be likely to yield information important in history or prehistory;

Qualifies under Criteria Considerations A through G (see Manual).

Does not meet any of the above National Register criteria.

39. Area(s) of Significance:

Architecture; Commerce; Ethnic Heritage / European

40. Period of Significance: **ca. 1904 - 1950**

41. Level of Significance:

National:

State:

Local: **xx**

42. Statement of Significance

The Colacci's Restaurant building is historically significant, relative to National Register Criterion A, for its association with commercial development in Louisville during the first half of the twentieth century. The building is also important for its association with the Colacci family, and Louisville's rich heritage of Italian restaurants. This association, though, postdates the period of significance.

43. Assessment of historic physical integrity related to significance:

Substantially remodeled in 1955, and perhaps again in 1988, this building bears little resemblance to what it looked like during the period of significance. A comparison of the extant building, with an appraisal card photo from the period of significance, reveals a considerable loss of integrity. The building, thus, is no longer able to convey a sense of its historic significance. It may be regarded as ineligible for individual listing in the National Register of Historic Places, and as a non-contributing property within a potential downtown Louisville historic district.

VII. NATIONAL REGISTER ELIGIBILITY ASSESSMENT

44. National Register eligibility field assessment:

Eligible:

Not Eligible: **xx**

Need Data:

45. Is there National Register district potential?

Yes: **xx**

No:

Discuss: **Historic buildings along Main Street in downtown Louisville, which have retained a sufficient degree of historical integrity, could comprise a National Register historic district.**

If there is National Register district potential, is this building:

Contributing:

Noncontributing: **xx**

46. If the building is in an existing National Register district, is it:

Contributing: **n/a**

Noncontributing: **n/a**

VIII. RECORDING INFORMATION

47. Photograph numbers:

Roll: **CM-13, CM-14**

Frame(s): **21-22, 1, 3-4**

Negatives filed at: **City of Louisville, Administration
749 Main Street
Louisville, Colorado 80027**

48. Report title: **"Old Town" Louisville Historical Building Survey**

49. Date: **April 12, 2000**

50. Recorder(s): **Carl McWilliams**

51. Organization: **Cultural Resource Historians**

52. Address: **1607 Dogwood Court
Fort Collins, Colorado 80525**

53. Phone number: **970/493-5270**

Walnut Street

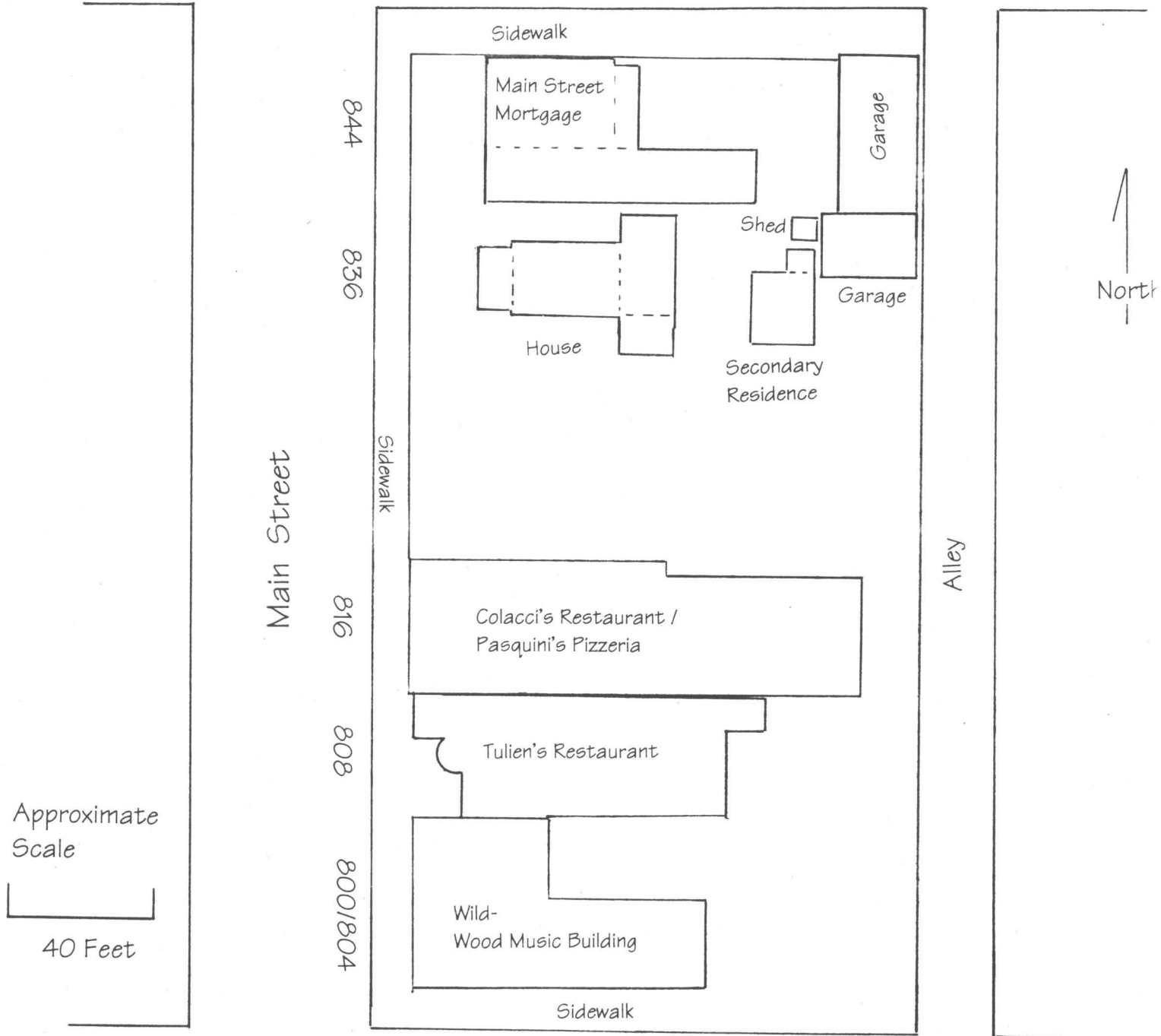

SKETCH MAP

816 Main Street, Louisville, Colorado

LOUISVILLE QUADRANGLE
COLORADO
7.5 MINUTE SERIES (TOPOGRAPHIC)

4964 11 SE
(ERIE)

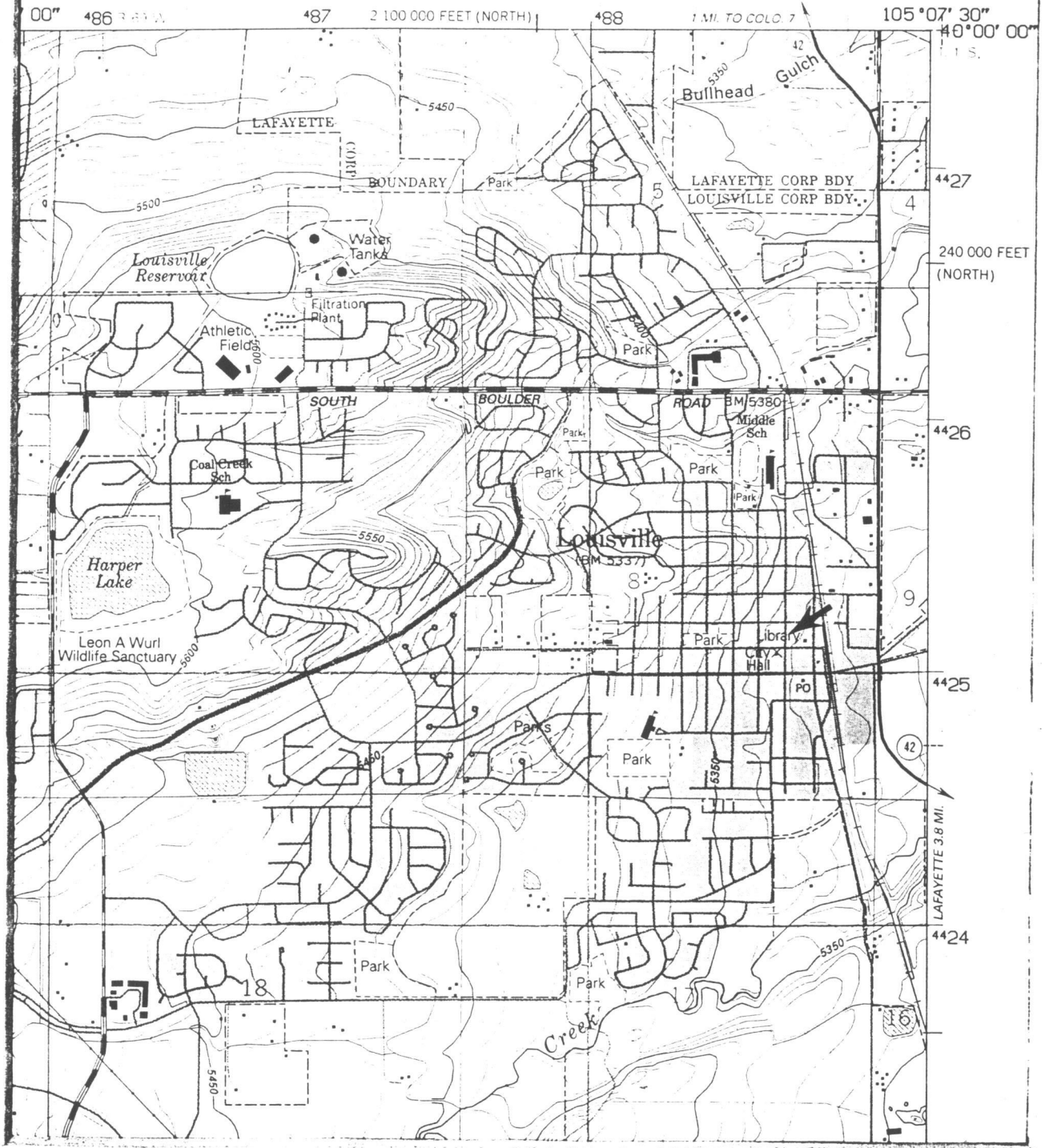

. . . LOCATION MAP . . .

816 Main Street, Louisville, Colorado



5BL8012 816 Main Street, Louisville
Colacci's Restaurant Building
27 April 2000
Negative located at: City of Louisville
 749 Main Street, Louisville, CO 80027
Photographed by Carl McWilliams
Roll CM-14 Frame 3
View to NW

