

COLORADO CULTURAL RESOURCE SURVEY

Architectural Inventory Form

(Page 1 of 5)

I. IDENTIFICATION

- 1. Resource number: **5BL935**
- 2. Temporary number: **N/A**
- 3. County: **Boulder**
- 4. City: **Louisville**
- 5. Historic building name: **Ostrander House; Lawrence House**
- 6. Current building name: **Dunlap House**
- 7. Building address: **741 Lincoln Avenue**
- 8. Owner name: **Gary H. Dunlap**
Owner address: **741 Lincoln Avenue
Louisville, CO 80027**

II. GEOGRAPHIC INFORMATION

- 9. P.M. **6th** Township **1S** Range **69W**
NW¼ of **SW**¼ of **NW**¼ of **SE**¼ of section **8**
- 10. UTM reference
Zone **13**
Easting: **488350**
Northing: **4425100**
- 11. USGS quad name: **Louisville, Colorado**
Year: **1965 (Revised 1994) 7.5'**
- 12. Lot(s): **1-4** Block: **9**
Addition: **Pleasant Hill** Year of Addition **1900**
- 13. Boundary Description and Justification: **This legally defined parcel encompasses but does not exceed the land historically associated with this property.**

Official Eligibility Determination

(OAHP use only)

- Date _____ Initials _____
- Determined Eligible - National Register
 - Determined Not Eligible - National Register
 - Determined Eligible - State Register
 - Determined Not Eligible - State Register
 - Needs Data
 - Contributes to eligible National Register District
 - Noncontributing to eligible National Register District

III. ARCHITECTURAL DESCRIPTION

- 14. Building plan (footprint, shape):
L-Shaped Plan
- 15. Dimensions in feet: **1405 square feet**
- 16. Number of stories: **1½**
- 17. Primary external wall material:
Brick
- 18. Roof configuration (enter one):
Gabled Roof / Cross Gabled Roof
- 19. Primary external roof material (enter one):
Asphalt Roof
- 20. Special features (enter all that apply):
Porch
Segmental Arches
Stained Glass
Fence

22. Architectural style / building type:

Other Style
(Brick Masonry
Gabled L Dwelling)



21. General Architectural Description

One of Louisville's few examples of a historic brick residence, this 1½-story dwelling is set on a low coursed sandstone foundation. The exterior walls are red brick, laid in common bond (headers every seventh course), and there are three belt courses, described as follows: two rows of projecting stretchers form a belt course at the level of the first story window sills; two rows of projecting stretchers, separated by a course of bricks laid in a sawtooth pattern, creates a belt course at the level of the first story window lintels; the third belt course is formed by two courses of projecting stretchers, at the level of the upper half story window sills. The building is covered by a cross gabled roof, with grey asphalt shingles and boxed eaves. A red brick chimney is located on the exterior of the south elevation. Window patterns are predominantly 3/1 double-hung sash (ribbon style), with transom lights, painted white wood frames, stone lugsills, and segmental brick arch headers. A stained natural brown wood-paneled front entry door, with a stained glass upper sash light, and with decorative carved panels, and with a dentil course in the locking rail, is located on the east elevation. This door has a distinctive, painted white, wood screen door, and opens onto a painted red tongue-and-groove wood porch, located at the north end of the facade (east elevation). The porch has painted buff red concrete half walls, and painted white turned columns, with brackets, supporting a hipped and gabled porch roof. A wood frieze appears along the roof eave. A 10-light glass-in-wood-frame door, with flanking sidelights, opens onto a concrete patio, covered by a flat roof balcony, on the west elevation. This roof also serves as an upper half-story balcony. A painted white wood door, with a segmental brick arch header, opens onto the balcony.

A **Carriage House**, or Garage, is located west of the house. This 1½-story brick building is supported by a concrete foundation, and has red brick walls, laid in common bond. Painted beige square-cut wood shingles appear in the upper gable ends. The roof is a steeply-pitched side-gable, with a short shed-roofed extension to the north. A gabled wall dormer, with two single-light windows, topped by clerestory windows, are located on the south elevation. 1/1 double-hung sash windows are located in the upper gable ends, on the west and east elevations. A large metal roll-away garage door opens onto a concrete driveway which extends to Spruce Street to the north.

29. Construction History (include description and dates of major additions, alterations, or demolitions:

Boulder County Assessor records indicate that this building was constructed in 1905. This date is plausible given the house's architectural character, and that the Pleasant Hill Addition was platted in 1900. A wood-frame, shed-roofed addition, to the north end of the west elevation, appears to be more than fifty years old. The Carriage House appears to date from the period of significance.

23. Landscape or setting special features:

This property is located at the southwest corner of Lincoln Avenue and Spruce Street, in an older residential neighborhood west of downtown Louisville. A large planted grass side yard to the south, and a small back yard to the west, are enclosed by a wrought iron fence which parallels Lincoln Avenue, and by a woven wire fence along the south property line. An irrigation ditch runs behind the property, along the north property line. There is no alley.

24. Associated buildings, features, or objects
Carriage House/ Garage**IV. ARCHITECTURAL HISTORY****25. Date of Construction:**

Estimate

Actual **1905**

Source of information:

Boulder County Assessor Records**26. Architect:****n/a**

Source of information:

n/a**27. Builder/ Contractor:****unknown**

Source of information:

n/a**28. Original owner:****unknown**

Source of information:

n/a**30. Original location: **yes****Moved **no**Date of move(s) **n/a**

V. HISTORICAL ASSOCIATIONS

31. Original use(s): **Single Dwelling**
32. Intermediate use(s): **Single Dwelling**
33. Current use(s): **Single Dwelling**
34. Site type(s): **Residence**

35. Historical Background

This house was constructed a few years after the turn of the twentieth century, and has served as a single-family dwelling since that time. Little is known about the early residents and owners of this property. There is a good chance, though, that they were employed by area coal mines. During the late 1800s and early 1900s, Louisville's economy was principally based on the area's coal industry, and consequently, the livelihoods of most of the community's inhabitants were directly, or indirectly, dependent on the coal mines.

By the late 1920s (and perhaps earlier), this house had become the residence of Albert (Bert) H. and Mabel Ostrander. Having come to Louisville in the years prior to 1904, the Ostranders ran a bakery. They previously resided at 945 Spruce Street. Other members of the Ostrander family - Othello R. and Isabelle Ostrander - resided at 240 Lincoln Avenue. Othello Ostrander was employed as a laborer in the 1910s. Albert Ostrander passed away in the late 1940s, but Mabel, his widow, continued to reside in this house until the early-to-mid-1950s.

In the late 1950s, this was the home of Norris W. and Janice H. Olson. Mr. Olson was employed at Wards. In the early 1960s, this property was acquired by Leonard B. and Clara M. Lawrence. The Lawrences, who had previously resided at 564 Lincoln Avenue, lived here until the early 1990s. The property's current owner and resident is Gary Dunlap. He has lived here since 1994.

36. Sources of Information

(Boulder County) "Real Estate Appraisal Card - Urban Master", on file at the Boulder Carnegie Library.

Polk's Boulder County Directory [generally published annually], Denver, Kansas City, and Salt Lake City: R.L. Polk and Company Publishers.

Polk's Longmont City Directory, [generally published annually], Denver, Kansas City, and Salt Lake City: R.L. Polk and Company, Publishers, 1966 - 1997.

Conarroe, Carolyn. *The Louisville Story*, Louisville: Louisville Times Inc., 1978.

VI. SIGNIFICANCE

37. Local landmark designation:

Yes

No **xx**

Date of Designation: n/a

38. Applicable National Register Criteria

xx A. Associated with events that have made a significant contribution to the broad patterns of our history;

B. Associated with the lives of persons significant in our past;

xx C. Embodies the distinctive characteristics of a type, period, or method of construction, or represents the work of a master, or that possess high artistic values, or represents a significant and distinguishable entity whose components may lack individual distinction;

D. Has yielded, or may be likely to yield information important in history or prehistory;

Qualifies under Criteria Considerations A through G (see Manual).

Does not meet any of the above National Register criteria.

39. Area(s) of Significance:

Architecture; Community Planning and Development

40. Period of Significance: 1905 - 1950

41. Level of Significance:

National:

State:

Local: **xx**

42. Statement of Significance

This house is historically significant, relative to National Register Criterion A, for its association with residential development in Louisville during the first half of the twentieth century. The house is architecturally significant, under National Register Criterion C, as a relatively rare brick residence in Louisville.

43. Assessment of historic physical integrity related to significance:

This house displays an overall high degree of historical integrity. There have been no additions, and no overt alterations, within the past fifty years. The Carriage House, is also contributes to the property's sense of historical significance, although its upper half story appears to have been altered.

VII. NATIONAL REGISTER ELIGIBILITY ASSESSMENT

44. National Register eligibility field assessment:

Eligible: **xx**

Not Eligible:

Need Data:

45. Is there National Register district potential?

Yes: **xx**

No:

Discuss: **Historic buildings in this neighborhood, that have retained a sufficient measure of their integrity, may have the potential to comprise a National Register historic district.**

If there is National Register district potential, is this building:

Contributing: **xx**

Noncontributing:

46. If the building is in an existing National Register district, is it:

Contributing: **n/a**

Noncontributing: **n/a**

VIII. RECORDING INFORMATION

47. Photograph numbers:

Roll: **CM-7**

Frame(s): **24-28**

Negatives filed at: **City of Louisville, Administration
749 Main Street
Louisville, Colorado 80027**

48. Report title: **"Old Town" Louisville Historical Building Survey**

49. Date: **April 5, 2000**

50. Recorder(s): **Carl McWilliams**

51. Organization: **Cultural Resource Historians**

52. Address: **1607 Dogwood Court
Fort Collins, Colorado 80525**

53. Phone number: **970/493-5270**

Spruce Street

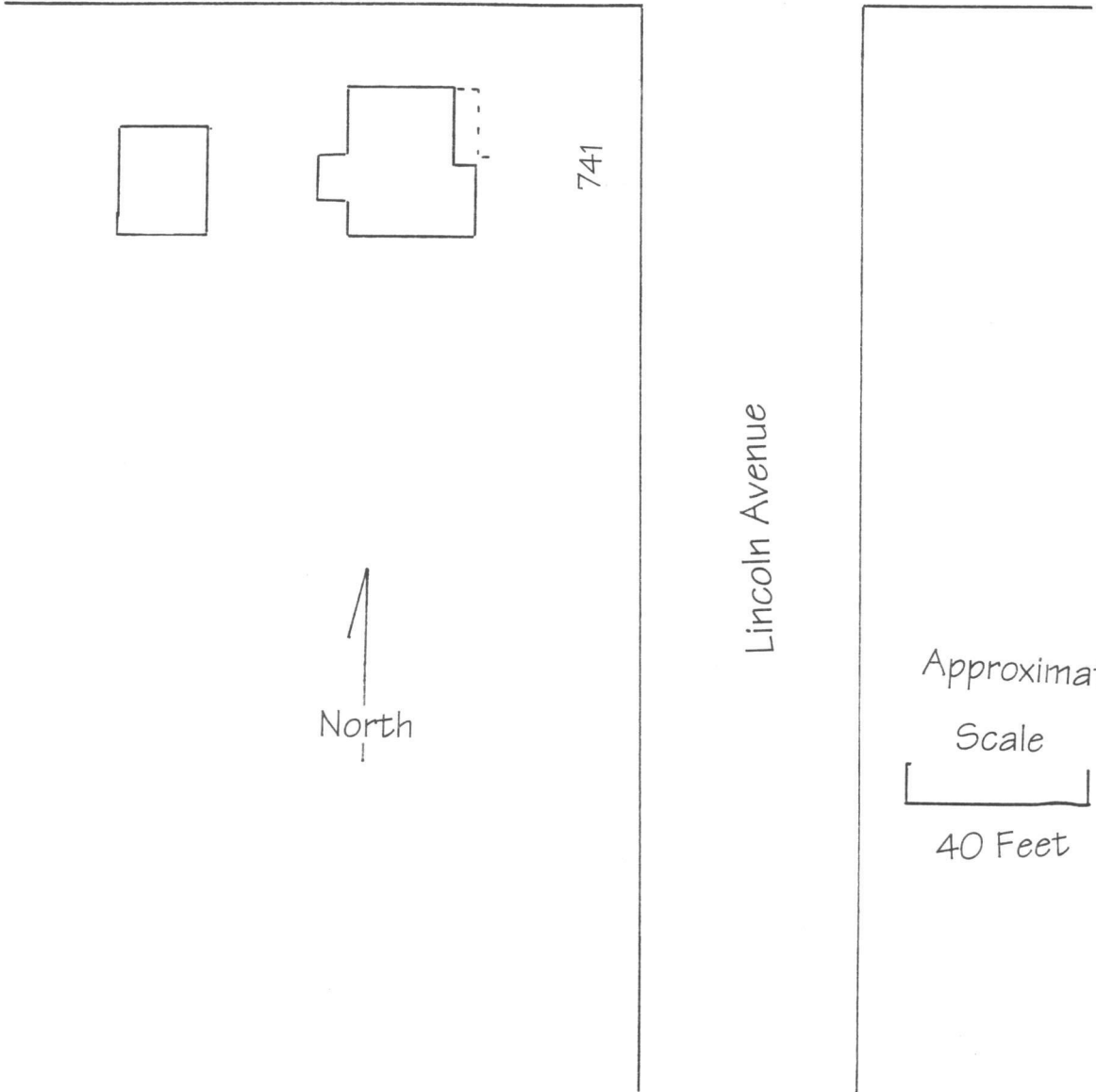

. . . SKETCH MAP . . .

741 Lincoln Avenue, Louisville, Colorado

LOUISVILLE QUADRANGLE
COLORADO
7.5 MINUTE SERIES (TOPOGRAPHIC)

4964 11 SE
(ERIE)

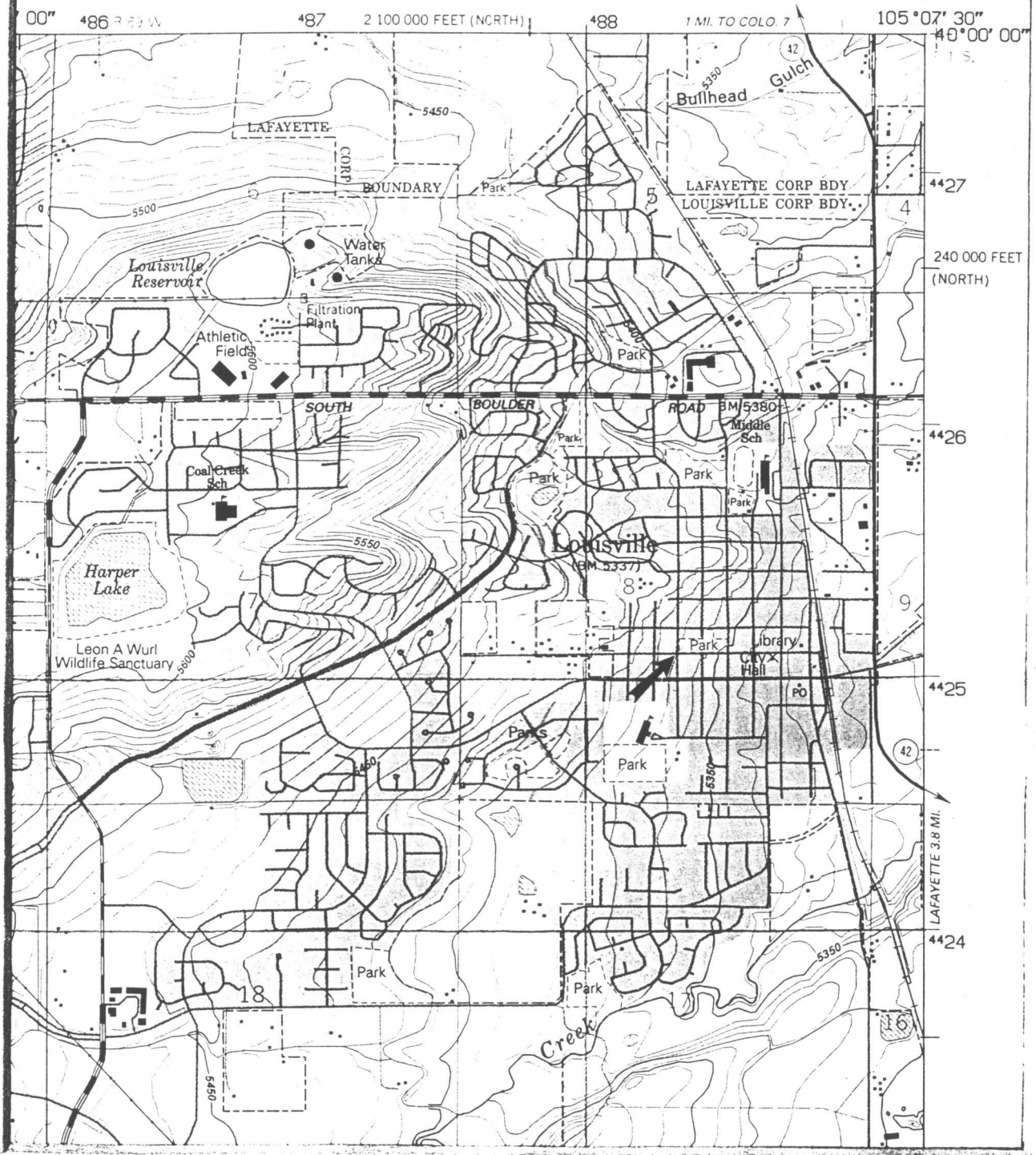

• • • LOCATION MAP • • •

741 Lincoln Avenue, Louisville, Colorado



741 Lincoln Avenue

