

COLORADO CULTURAL RESOURCE SURVEY

Architectural Inventory Form

(Page 1 of 5)

I. IDENTIFICATION

- 1. Resource number: **5BL8006**
- 2. Temporary number: **N/A**
- 3. County: **Boulder**
- 4. City: **Louisville**
- 5. Historic building name: **D'Haillecourt House**
- 6. Current building name: **Fleming House**
- 7. Building address: **601 Main Street**
- 8. Owner name: **Donald L. Fleming**
Owner address: **P.O. Box 808**
Louisville, CO 80027

II. GEOGRAPHIC INFORMATION

- 9. P.M. **6th** Township **1S** Range **69W**
SW¼ of **SW**¼ of **NE**¼ of **SE**¼ of section **8**
- 10. UTM reference
Zone **13**
Easting: **488760**
Northing: **4424900**
- 11. USGS quad name: **Louisville, Colorado**
Year: **1965 (Revised 1994) 7.5'**
- 12. Lot(s): **26** Block: **5**
Addition: **Original Town of Louisville** Year of Addition **1878**
- 13. Boundary Description and Justification: **This legally defined parcel encompasses but does not exceed the land historically associated with this property.**

22. Architectural style / building type:

Other Style
(Wood Frame Side Gabled Dwelling)



Official Eligibility Determination

(OAHP use only)

Date _____ Initials _____

- Determined Eligible - National Register
- Determined Not Eligible - National Register
- Determined Eligible - State Register
- Determined Not Eligible - State Register
- Needs Data
- Contributes to eligible National Register District
- Noncontributing to eligible National Register District

III. ARCHITECTURAL DESCRIPTION

- 14. Building plan (footprint, shape):
Rectangular Plan
- 15. Dimensions in feet: **840 square feet**
- 16. Number of stories: **one**
- 17. Primary external wall material
Metal / Steel
- 18. Roof configuration (enter one):
Gabled Roof / Front Gabled Roof
- 19. Primary external roof material (enter one):
Wood Roof / Shingle Roof
- 20. Special features (enter all that apply):
Porch
Fence

Survey completed April 2000

21. General Architectural Description

Located at the northwest corner of Main and Elm Streets, this building is a one-story wood-frame residence, with a simple rectangular plan. Significantly altered from its historic appearance in the 1960s, this building is supported by a red clay tile foundation, covered with concrete. The exterior walls are clad with non-original horizontal and vertical metal siding, over earlier horizontal wood siding. The roof is a moderately-pitched side gable (originally a side gable), with wood shingles and boxed eaves. A large, non-original single-light fixed-pane window, flanked by single-light casement windows, is located on the east elevation. Windows otherwise are non-original 1x1 horizontal sliders, in metal frames. A stained natural brown wood-paneled door, with an aluminum storm door, opens onto a 4-step concrete porch on the south elevation. A stained natural brown solid wood door, with an aluminum storm door, opens onto a concrete stoop, and small concrete driveway on the west elevation. The driveway extends to Elm Street to the south. There is no garage. An ornate wrought iron fence, which encloses the yard, was produced in Louisville, according to Donald Fleming.

29. Construction History (include description and dates of major additions, alterations, or demolitions:

This residence was built in 1892, according to Boulder County Assessor records. An 1893 Sanborn insurance map corroborates that the house was built prior to 1893. In the early 1960s, the house was substantially altered and modernized by its owner, Donald Fleming. The front entrance was changed from the east elevation to the south elevation, all of the windows were altered, and the house was clad with metal siding. The interior was renovated as well.

23. Landscape or setting special features:

This property is located at the northwest corner of Main and Elm Streets, south of downtown Louisville.

24. Associated buildings, features, or objects
n/a**IV. ARCHITECTURAL HISTORY****25. Date of Construction:**

Estimate

Actual **1892**

Source of information:

Boulder County Assessor records; Sanborn insurance map, 1893.**26. Architect:**

n/a

Source of information:

n/a

27. Builder/ Contractor:**unknown**

Source of information:

n/a

28. Original owner:**unknown**

Source of information:

n/a

30. Original location: yesMoved **no**Date of move(s) **n/a**

V. HISTORICAL ASSOCIATIONS

31. Original use(s): **Single Dwelling**
32. Intermediate use(s): **Single Dwelling**
33. Current use(s): **Single Dwelling**
34. Site type(s): **Residence**

35. Historical Background

Built in 1892, this building has served as a single-family dwelling since that time. According to Donald Fleming, its owner since 1960, the building also housed a tailor shop in its early days. Although the home's earliest owners are unknown, there is a good chance that some members of their families were employed at area coal mines. During the late 1800s and early 1900s, Louisville's economy was based, to a great extent, on the area's coal industry. As a result, the livelihoods of most of the community's inhabitants were directly, or indirectly, dependent on coal.

In the 1950s, this was the residence of Desire and Marian D'Haillecourt. Mr. D'Haillecourt was a miner, while for a time, in the late 1950s, Mrs. D'Haillecourt was employed as a dishwasher at the Blue Parrot Cafe. Previously, the D'Haillecourts had lived at 720 Mead Street in Louisville. Pat D'Haillecourt, a laborer, was also listed at that address in the 1951 Boulder County Directory. This house's next resident was Helen M. McMarle, who owned it for just a few years in the late 1950s. In August 1960, she sold the property to its current owners Donald and Sandra Fleming. Mr. Fleming is a general contractor, and has operated Fleming Construction for many years. Since 1960, he has resided in the house next door to the west, while maintaining this house as a rental. Mr. Fleming's mother lived in this house for awhile in the 1960s, after her husband passed away. Donald Fleming was born in Salina, Kansas, and moved to Boulder with his family at age five. He grew up in Boulder, where his dad ran a grocery store.

36. Sources of Information

(Boulder County) "Real Estate Appraisal Card - Urban Master", on file at the Boulder Carnegie Library.

Fleming, Donald. Oral interview with Carl McWilliams, April 28, 2000.

Polk's Boulder County Directory [generally published annually], Denver, Kansas City, and Salt Lake City: R.L. Polk and Company Publishers.

Polk's Longmont City Directory, [generally published annually], Denver, Kansas City, and Salt Lake City: R.L. Polk and Company, Publishers, 1966 - 1997.

Sanborn Fire Insurance Maps, dated August 1893, November 1900, and August 1908.

VI. SIGNIFICANCE

37. Local landmark designation:

Yes

No **xx**

Date of Designation: n/a

38. Applicable National Register Criteria

A. Associated with events that have made a significant contribution to the broad patterns of our history;

B. Associated with the lives of persons significant in our past;

C. Embodies the distinctive characteristics of a type, period, or method of construction, or represents the work of a master, or that possess high artistic values, or represents a significant and distinguishable entity whose components may lack individual distinction;

D. Has yielded, or may be likely to yield information important in history or prehistory;

Qualifies under Criteria Considerations A through G (see Manual).

xx Does not meet any of the above National Register criteria.

39. Area(s) of Significance:

Community Planning and Development

40. Period of Significance: 1892 - 1950

41. Level of Significance:

National:

State:

Local: **xx**

42. Statement of Significance

This house was historically significant, relative to National Register Criterion A, for its association with residential development in Louisville in the late 1800s, and during the first half of the twentieth century. The house was architecturally significant as well, under National Register Criterion C, as an example of a wood frame front gabled dwelling. Due to a complete loss of integrity, however, the house should be considered ineligible for individual listing in the National Register of Historic Places. The ornate wrought iron fence is a historically significant feature, however.

43. Assessment of historic physical integrity related to significance:

This house's historical integrity has been severely impacted by numerous alterations in the 1960s. It is no longer able to convey a sense of its historic past.

VII. NATIONAL REGISTER ELIGIBILITY ASSESSMENT

44. National Register eligibility field assessment:

Eligible:

Not Eligible: **xx**

Need Data:

45. Is there National Register district potential?

Yes:

No: **xx**

Discuss: **Houses and other buildings in this area south of downtown Louisville, do not collectively display sufficient historical integrity to qualify as a National Register Historic District.**

If there is National Register district potential, is this building:

Contributing: **n/a**

Noncontributing: **n/a**

46. If the building is in an existing National Register district, is it:

Contributing: **n/a**

Noncontributing: **n/a**

VIII. RECORDING INFORMATION

47. Photograph numbers:

Roll: **CM-12**

Frame(s): **1-3, 8**

Negatives filed at: **City of Louisville, Administration
749 Main Street
Louisville, Colorado 80027**

48. Report title: **"Old Town" Louisville Historical Building Survey**

49. Date: **April 5, 2000**

50. Recorder(s): **Carl McWilliams**

51. Organization: **Cultural Resource Historians**

52. Address: **1607 Dogwood Court
Fort Collins, Colorado 80525**

53. Phone number: **970/493-5270**

Pine Street

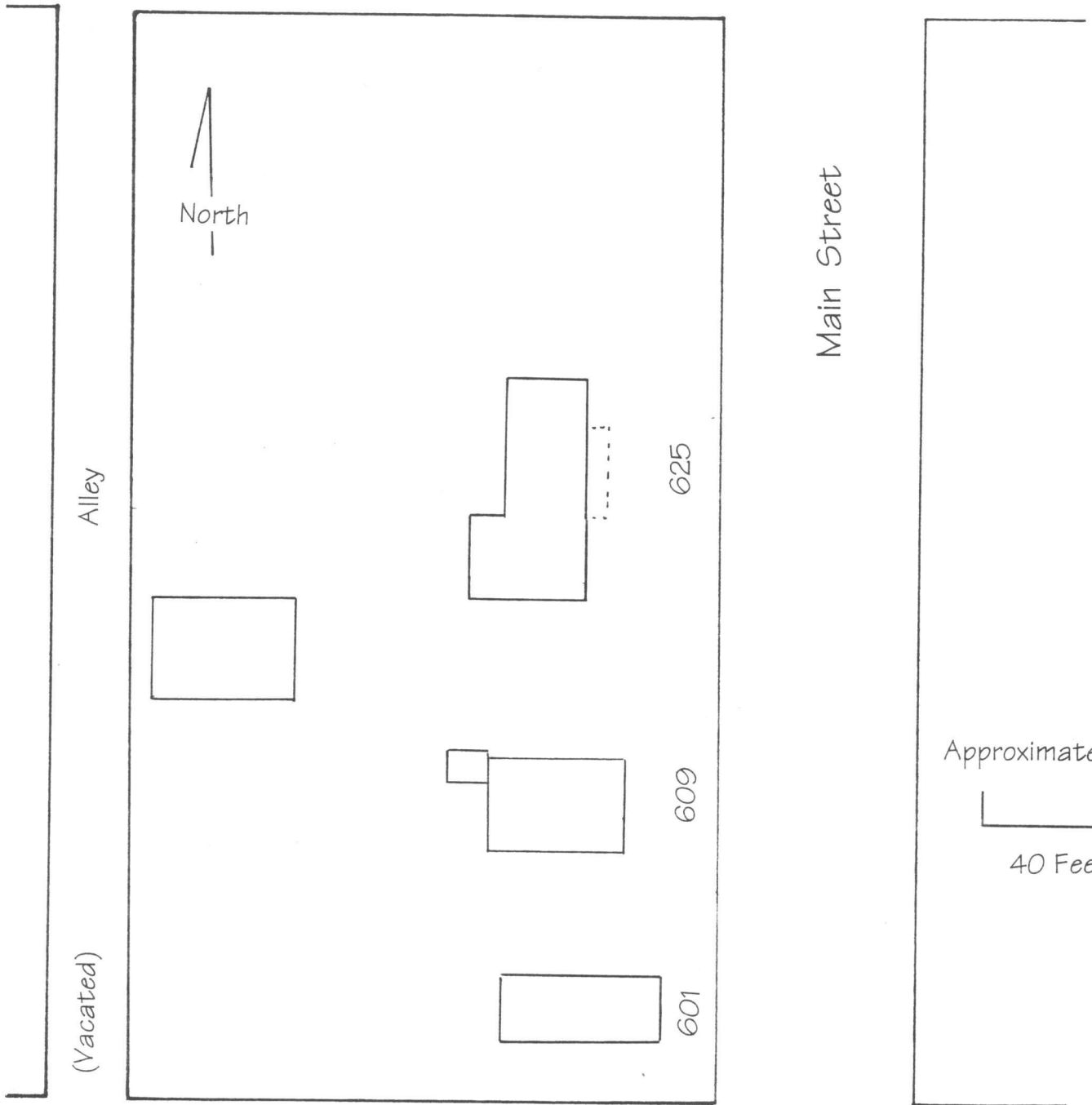

Elm Street

• • • SKETCH MAP • • •

601 Main Street, Louisville, Colorado



. . . LOCATION MAP . . .

601 Main Street, Louisville, Colorado



