

COLORADO CULTURAL RESOURCE SURVEY

Architectural Inventory Form

(Page 1 of 5)

I. IDENTIFICATION

- 1. Resource number: **5BL7973**
- 2. Temporary number: **N/A**
- 3. County: **Boulder**
- 4. City: **Louisville**
- 5. Historic building name: **Johnson House**
- 6. Current building name: **Johnson House**
- 7. Building address: **425 Grant Avenue**
- 8. Owner name: **Mary Louise Johnson**
Owner address: **425 Grant Avenue**
Louisville, CO 80027

II. GEOGRAPHIC INFORMATION

- 9. P.M. **6th** Township **1S** Range **69W**
NW¼ of **SW**¼ of **SW**¼ of **SE**¼ of section **8**
- 10. UTM reference
Zone **13**
Easting: **488360**
Northing: **4424700**
- 11. USGS quad name: **Louisville, Colorado**
Year: **1965 (Revised 1994) 7.5'**
- 12. Lot(s): **n/a** Block: **n/a**
Addition: **n/a** Year of Addition: **n/a**
- 13. Boundary Description and Justification: **This legally defined parcel encompasses but does not exceed the land historically associated with this property.**

Official Eligibility Determination

(OAHP use only)

Date _____ Initials _____

- Determined Eligible - National Register
- Determined Not Eligible - National Register
- Determined Eligible - State Register
- Determined Not Eligible - State Register
- Needs Data
- Contributes to eligible National Register District
- Noncontributing to eligible National Register District

III. ARCHITECTURAL DESCRIPTION

- 14. Building plan (footprint, shape):
Rectangular
- 15. Dimensions in feet: **~ 1144 square feet**
- 16. Number of stories: **One**
- 17. Primary external wall material:
Metal / Aluminum
- 18. Roof configuration (enter one):
Cross Gabled Roof
- 19. Primary external roof material (enter one):
Wood Roof / Shingle Roof
- 20. Special features (enter all that apply):
Porch
Chimney

22. Architectural style / building type:

Other Style
(Wood Frame Cross Gabled Dwelling)



21. General Architectural Description

The Johnson farmhouse is a wood frame residence which rests on a stone foundation, with a partial basement. The exterior walls are white horizontal aluminum siding, and the intersecting gables roof is covered with wood shingles. The roof eaves are boxed, and there is one red brick chimney located on the ridge. Window patterns include 1/1 double-hung sash, 2/2 double-hung sash, and 1x1 horizontal sliders, all with painted white wood frames and surrounds, and with exterior metal storm windows. An enclosed hipped-roof front porch, on the house's east elevation, features ten meal-framed windows, and two sets of paired 1/1 double-hung sash windows. Two concrete and sandstone steps, flanked by low concrete kneewalls, with black wrought iron railings, lead to a silver metal storm door at the exterior of the porch. The steps, and a portion of the front sidewalk, are covered by a green fiberglass hood, with white wrought iron supports. A distinctive, painted white, wood-paneled door, with carved scrollwork and a dentil course in its top and locking rails, leads from the porch into the house's interior. An enclosed hipped-roof rear porch addition is located on the building's west elevation. A solid wood door, with an aluminum storm door, enters into the rear porch at the west end of the south elevation.

A large **Garage** is located to the south of the house. This structure features a concrete slab foundation and floor, red glazed brick walls, and a shed roof with rolled green asphalt roofing material over 1x wood decking and 2x wood rafters. The roof features stepped side gables on the north and south elevations. A band of three 4-light hopper windows, with painted white wood frames and surrounds, are located on the north elevation. Large, painted white, vertical wood plank horizontal sliding garage doors, side hinged with metal strap hinges, are located on the east elevation. A single painted white wood-paneled door is located at the north end of the east elevation.

A **Coal Shed** is located just to the south of the garage. This small building rests on a wood timbers on grade foundation, and features board-and-batten walls, and a shed roof with rolled green asphalt roofing material. A vertical wood plank door, side hinged with metal strap hinges, is located on the east elevation.

Located to the south and west of the coal shed, are the **Stone Foundation Ruins** of a large **Chicken House**.

To the west of the foundation ruins, is a **Chicken House** which still stands. This structure has low stone perimeter walls foundation, a concrete slab floor, and red glazed brick walls, with concrete pargeting. The building is covered by a monitor roof, with rolled green asphalt roofing material over 1x wood decking and 2x wood rafters. Multiple chicken wire covered openings are located along the lower south elevation, and there are fourteen clerestory windows along the south elevation. Three vertical wood plank doors, side hinged with metal strap hinges, are located on the south elevation as well.

29. Construction History (include description and dates of major additions, alterations, or demolitions:

This house was built during the early 1900s. At some point, a hipped-roof enclosed rear porch addition was built onto the west (rear) elevation. The front porch was likely originally open, but is now enclosed.

23. Landscape or setting special features:

This property is located southwest of the intersection of Grant Avenue and Hutchinson Street, to the south of Louisville's older neighborhoods. A gravel lane leads to the property from Hutchinson. A large planted grass lawn surrounds the house, with two large fir threes, and many smaller deciduous trees.

**24. Associated buildings, features, or objects
Garage, Coal Shed, Chicken House****IV. ARCHITECTURAL HISTORY**

25. Date of Construction:
Estimate **ca. 1920**
Actual

Source of information:
field estimate

26. Architect:
n/a

Source of information:
n/a

27. Builder/ Contractor:
unknown

Source of information:
n/a

28. Original owner:
Jonas and Hannah Johnson

Source of information:
Mary Johnson

30. Original location: **yes**
Moved **no**
Date of move(s) **n/a**

V. HISTORICAL ASSOCIATIONS

31. Original use(s): **Single Dwelling**
32. Intermediate use(s): **Single Dwelling**
33. Current use(s): **Single Dwelling**
34. Site type(s): **Farm Complex**

35. Historical Background

This property has been associated with the Johnson family since the early 1920s. Jonas and Hannah Johnson were Swedish immigrants, who settled in the Berthoud area in the early 1900s, before moving to Louisville circa 1920. The Johnsons raised five children, including Roy, Ralph, Harry, Daisy, and Gladys. On this place, the Johnsons had a small farm, growing wheat and corn, along with milk cows and poultry. To make ends meet, Jonas also worked in area coal mines, as well as in hard-rock mines around Gold Hill.

Ralph Johnson, Jonas' and Hannah's son, was born June 1, 1907. As he came of age, Ralph gradually took over the responsibility of the family farm, and continued to live here after his parents' deaths. On June 27, 1949, Ralph married Mary Bodnar in Louisville. Born in 1909, Mary was the daughter of Anna and George Bodnar, who had immigrated to the United States from Slovenia (present-day Czechoslovakia) circa 1905. Mary grew up in Rockvale, Colorado, before moving to Louisville with her parents and two brothers, George Jr. and Michael.

After their marriage in 1949, Ralph and Mary Johnson had no children. They continued to farm here for many years, and Ralph also worked in Tungsten mines in the mountains from time-to-time. Ralph passed away in 1992, but Mary continues to live here in retirement.

36. Sources of Information

(Boulder County) "Real Estate Appraisal Card - Urban Master", on file at the Boulder Carnegie Library.

Johnson, Mary Louise. Oral interview with Carl McWilliams, February 1, 2000.

Polk's Boulder County Directory [generally published annually], Denver, Kansas City, and Salt Lake City: R.L. Polk and Company Publishers.

Architectural Inventory Form

(Page 4 of 5)

VI. SIGNIFICANCE

37. Local landmark designation:

Yes

No **xx**

Date of Designation: n/a

38. Applicable National Register Criteria

xx A. Associated with events that have made a significant contribution to the broad patterns of our history;

B. Associated with the lives of persons significant in our past;

xx C. Embodies the distinctive characteristics of a type, period, or method of construction, or represents the work of a master, or that possess high artistic values, or represents a significant and distinguishable entity whose components may lack individual distinction;

D. Has yielded, or may be likely to yield information important in history or prehistory;

Qualifies under Criteria Considerations A through G (see Manual).

Does not meet any of the above National Register criteria.

39. Area(s) of Significance:

Agriculture; Ethnic Heritage / European

40. Period of Significance: **ca. 1920**

41. Level of Significance:

National:

State:

Local: **xx**

42. Statement of Significance

This property is historically significant because it is one of the last agricultural properties located within the Louisville city limits, and in close proximity to downtown and the city's older residential neighborhoods. The property accrues additional significance because it has long been associated with a single family, and because its history has been well-documented. Jonas Johnson, and later his son, Ralph Johnson, are notable because they represent three historic themes - agriculture, coal mining, and hard-rock mining. Although they were principally farmers, the Johnsons also turned to mining to earn a living. Architecturally, the house exemplifies the type, or method of construction, of a vernacular wood frame farmhouse.

43. Assessment of historic physical integrity related to significance:

This property overall displays a relatively high degree of historical integrity. An enclosed hipped-roof rear porch addition to the rear elevation is probably more than fifty years old. The house's aluminum siding is not historic. Some integrity of setting has been lost by the loss of one large chicken house. One other chicken house remains, however.

VII. NATIONAL REGISTER ELIGIBILITY ASSESSMENT

44. National Register eligibility field assessment:

Eligible: **xx**

Not Eligible:

Need Data:

45. Is there National Register district potential?

Yes:

No: **xx**

Discuss: **Located to the south of Louisville's older residential neighborhoods, this property is too isolated to be part of a National Register historic district.**

If there is National Register district potential, is this building:

Contributing: **n/a**

Noncontributing: **n/a**

46. If the building is in an existing National Register district, is it:

Contributing: **n/a**

Noncontributing: **n/a**

VIII. RECORDING INFORMATION

47. Photograph numbers:

Roll: **CM-2**

Frame(s): **3-10**

Negatives filed at: **City of Louisville, Administration
749 Main Street
Louisville, Colorado 80027**

48. Report title: **"Old Town" Louisville Historical Building Survey**

49. Date: **February 1, 2000**

50. Recorder(s): **Carl McWilliams**

51. Organization: **Cultural Resource Historians**

52. Address: **1607 Dogwood Court
Fort Collins, Colorado 80525**

53. Phone number: **970/493-5270**

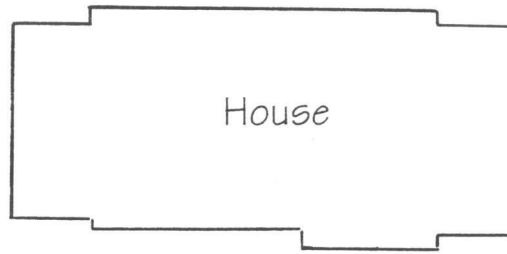

House

~150 Feet
To Hutchinson Street →

Gravel Lane

Approximate Scale



20 Feet

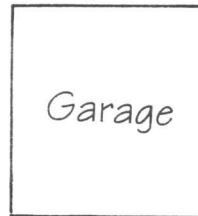

Garage



Shed

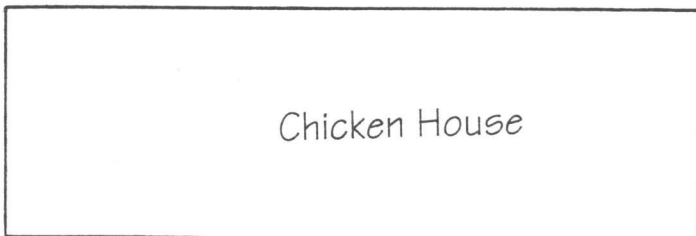

Chicken House



Stone
Foundation
Ruins

. . . SKETCH MAP . . .



. . . LOCATION MAP . . .

425 Grant Avenue, Louisville, Colorado

